

# WATEROUS

Form Number: F-3044

Issue Date: Jul 17, 2024

## AQUIS™ ULTRAFLOW 500 Hydraulic and Foam Systems Installation and Operation

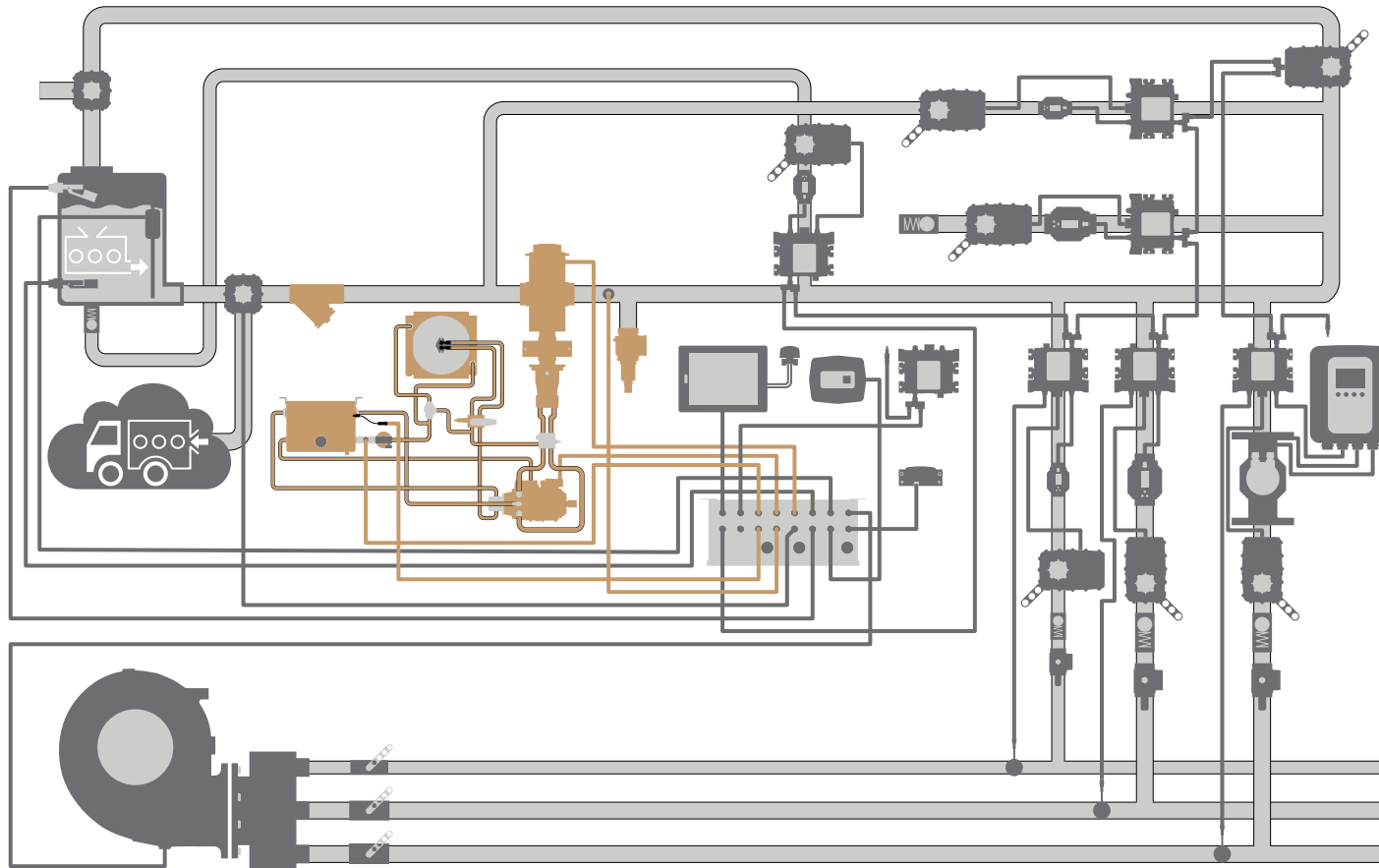

Waterous Company • 125 Hardman Avenue South • South Saint Paul, MN 55075 • (651) 450-5000

[www.waterousco.com](http://www.waterousco.com)



# Table of Contents

---

<b>Safety</b>	<b>4</b>	<b>Installation</b>	<b>55</b>
Safety Precautions	4	Installation Overview	55
<b>Introduction</b>	<b>5</b>	Preparing for the Installation	55
Using this Document	5	Modifying the Equipment	55
Viewing the Document Electronically	5	Optional Equipment	55
Printing the Document	5	Determining Cable and Wire Routing	55
Additional Documentation	5	Plumbing Layout	56
<b>Overview</b>	<b>6</b>	Concentrate Supply Component Location	58
Aquis UltraFlow Industrial Foam Proportioner System	6	Hydraulic Component Layout	60
Hydraulic Components	10	Installing the Hydraulic Hoses	62
Concentrate Pump Assembly	12	Installing the Hydraulic Motor and Concentrate Pump	64
Spider Coupler	14	Assembling the Fan Control Circuit	65
Hydraulic Motor	16	Assembling the Hydraulic Reservoir	66
Hydraulic Pump	18	Installing the Concentrate Strainer	67
Hydraulic Fan Pump	20	Installing the Pressure Relief Valve	68
Hydraulic Heat Exchanger	22	Installing the Pressure Transducer	69
Fan Control Circuit	24	Connecting the Hydraulic Pump to the Apparatus Drive	70
Loop Flush Manifold	26	Connecting the Concentrate Pump and Pressure Transducer	71
Bypass Valve	28	Connecting the Hydraulic Sensors and Hydraulic Pump	72
Hydraulic Reservoir	30	<b>Operation</b>	<b>73</b>
Hydraulic Level Sensor	32	Operating the Hydraulic System	73
Hydraulic Temperature Sensor	34	<b>Maintenance</b>	<b>74</b>
Hydraulic Temperature Switch	36	Maintenance Schedule	74
Hydraulic Suction Strainer	38		
Hydraulic Filter Components	40		
Concentrate Strainer	42		
Pressure Relief Valve	44		
Pressure Transducer	46		
3.0 Meter Sensor Cable	48		
0.5 Meter Sensor Cable	49		
Concentrate Pump Cable	50		
Concentrate Pump Cable—Schematic	51		
Hydraulic Pump Cable	52		
Hydraulic Pump Cable—Schematic	53		

## Safety Precautions

- Read and understand all the associated documentation before you begin operating the product.
- Contact Waterous when you have questions about operating or maintaining the equipment.
- Read and understand all the notices and safety precautions.
- Do not operate the equipment when safety guards are removed.
- Do not modify the equipment

 <b>WARNING</b>	
<p><b>High Pressure</b></p> <ul style="list-style-type: none"> <li>• Discharge ejected at high pressure can cause serious injury and damage.</li> <li>• Direct discharge away from people and equipment.</li> </ul>	

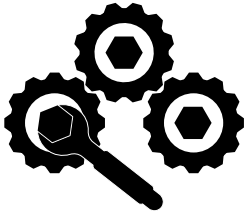
<b>NOTICE</b>	
<p><b>Modification</b></p> <ul style="list-style-type: none"> <li>• Modifying the equipment can damage components and void your warranty.</li> <li>• Do not modify the system or any of its components.</li> </ul>	

<b>NOTICE</b>	
<p><b>Before Operation</b></p> <ul style="list-style-type: none"> <li>• Read and understand all the instructions provided.</li> <li>• Check all fluid levels and replenish if necessary.</li> <li>• Remove all shipping plugs and install the operation plugs or caps.</li> </ul>	

 Read and understand all warnings following this symbol.

Use this document to install and operate your Waterous equipment. Understand the following conditions before proceeding:

- The instructions may refer to options or equipment that you may not have purchased with your system.
- The illustrations in this document are intended to convey concepts. Do not use the illustrations to determine physical attributes, placement, or proportion.
- Understand that your application may require additional steps, that are not described in the illustrations or instructions, to perform the installation.
- The equipment described in this document is intended to be installed by a person or persons with the necessary skills and knowledge to perform the installation.
- The equipment described in this document is intended to be operated by a person or persons with the basic knowledge of operating similar equipment.
- The information in this document is subject to change without notice.

This document is divided into the following sections:

#### SAFETY

This section describes general precautions and alert symbols in the document.

#### INTRODUCTION

This section is an overview of the document.

#### OVERVIEW

This section describes the components that make up the system.

#### INSTALLATION

This section describes the installation and initial setup procedures.

#### OPERATION

This section describes the equipment operation.

#### MAINTENANCE

This section describes any required maintenance.

## Using this Document

---

Use the guidelines below when viewing this document.

### Viewing the Document Electronically

---

- View this document in landscape orientation.
- Use the table of contents to navigate directly to that section.
- Text **with this appearance** is linked to a reference.

### Printing the Document

---

- The document is designed to be printed on both sides and in color.
- Use a 3-ring binder to store the document.

## Additional Documentation

---

Additional documentation is available through the MyWaterous login at [waterousco.com](http://waterousco.com). Use your serial number to gain access to the service parts list associated with your system. Dimensional drawings are available through the Waterous Service department.

## Aquis UltraFlow Industrial Foam Proportioner System

*Note: Make sure that the installer-supplied UltraFlow plumbing cannot trap fluid and allows fluid to be drained from the system when required.*

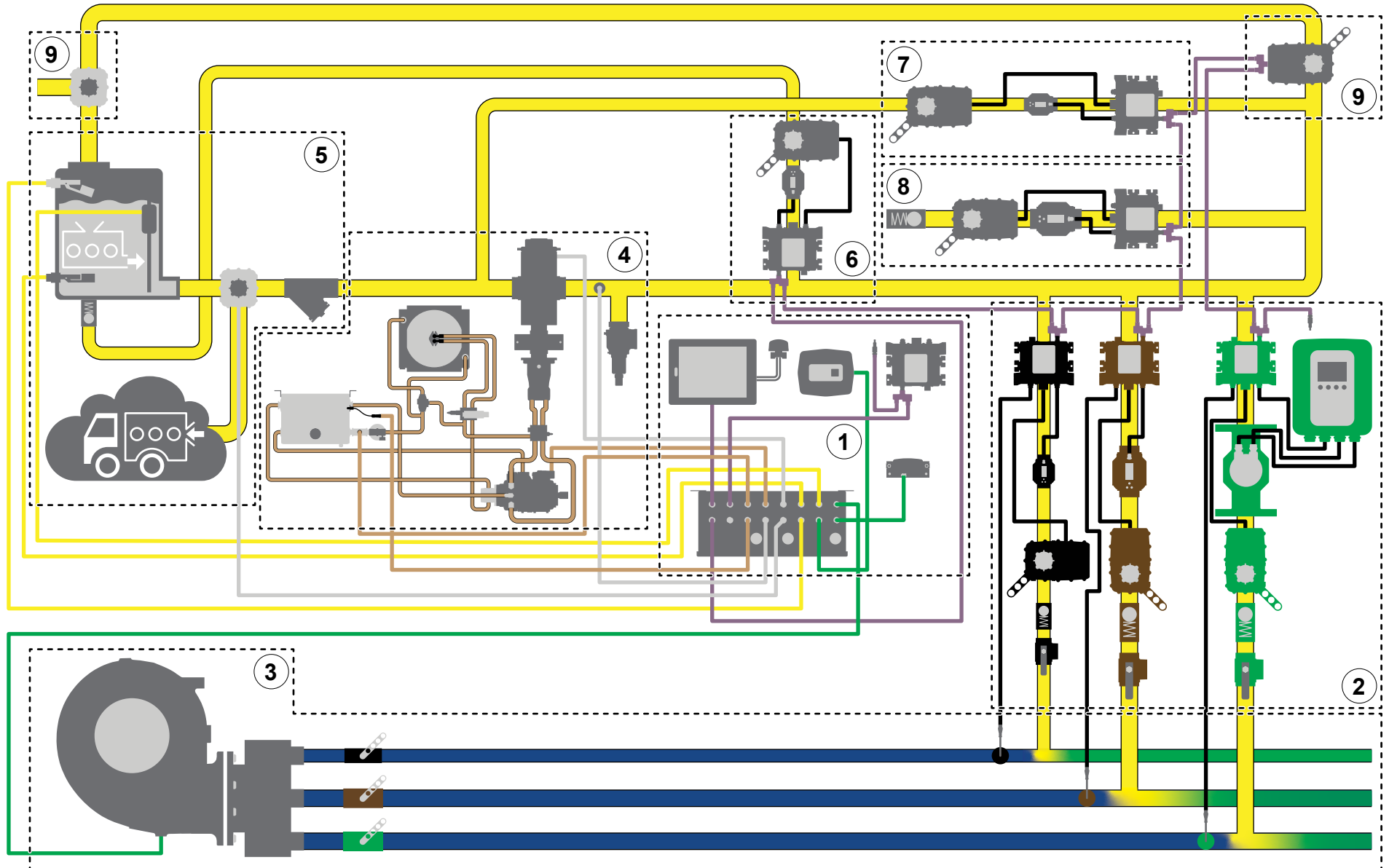

## Aquis UltraFlow Industrial Foam Proportioner System

The Aquis UltraFlow industrial foam proportioner system supplies concentrate into a solution-capable discharge line. A Tellurus™ control panel, or human machine interface (HMI), shows system activity and provides control of the system using a CANbus protocol. Foam concentrate is sourced from an on-board supply tank or an auxiliary source. The concentrate pump distributes concentrate through the discharge line assembly (DLA) using hydraulic components. The concentrate is then measured, controlled, and introduced into the solution-capable discharge line to produce foam solution. Understand that your application will include all or portions of the components described.

Subsystem	Description
1 Control system	<p>This monitors and controls the foam proportioner system. The components in this subsystem include:</p> <ul style="list-style-type: none"> <li>• Control panel—this displays system operation and provides control of the system.</li> <li>• Control box—this connects to various system components and contains the programmable logic controllers (PLCs).</li> <li>• Manual override panel—this disables the automatic control of the concentrate control valves.</li> <li>• Power relay panel—this enables and disables power to the DLA.</li> <li>• Remote I/O—this adds a node controller to the system for additional options required in your application.</li> <li>• Various cables—these provide communication and power to system components.</li> </ul>
2 Discharge line assembly	<p>This manages the concentrate injected into the solution-capable discharge. The system can control up to 19 DLAs. The components in this subsystem include:</p> <ul style="list-style-type: none"> <li>• Node controller—this connects to and controls the concentrate control valve, and reads the flowmeters and discharge pressure transducer.</li> <li>• CAN cable splitter—this connects the node controllers to one another and the control box.</li> <li>• DLA terminating resistor—this terminates the CAN connection on the last node controller or valve in the CAN chain.</li> <li>• Concentrate control valve—this controls the concentrate flow.</li> <li>• Magnetic flowmeter—this measures the concentrate flow.</li> <li>• Check valve—this prevents contamination of concentrate by preventing reverse fluid flow in the line.</li> <li>• Cal/Inject valve—this allows you to divert and collect water or concentrate when calibrating the your system.</li> </ul>
3 Solution-capable discharge	<p>This includes the installer-supplied water pump, distribution manifold, plumbing, and additional components that produce water flow. Additional components in this subsystem include:</p> <ul style="list-style-type: none"> <li>• Paddlewheel flowmeter—this measures the water flow in the discharge.</li> </ul> <p><b>Note:</b> You can install the flowmeter upstream or downstream of where the concentrate is injected into the waterway.</p> <ul style="list-style-type: none"> <li>• Water discharge pressure transducer—this measures the pressure at the pump discharge.</li> </ul> <p><b>Note:</b> Some applications do not allow for the discharge pressure to be measured at the pump, in those applications alternative measurement methods are used.</p> <ul style="list-style-type: none"> <li>• Solution discharge pressure transducer—this measures the pressure at the solution-capable discharge.</li> </ul>

## Aquis UltraFlow Industrial Foam Proportioner System

Subsystem	Description
4 Concentrate pump	<p>These components support, control, and power the concentrate pump. The components in this subsystem include:</p> <ul style="list-style-type: none"> <li>• Concentrate pump—this circulates the foam concentrate through the system.</li> <li>• Hydraulic motor—this drives the concentrate pump.</li> <li>• Hydraulic pump—this drives the hydraulic motor.</li> <li>• Hydraulic fan pump—this provides power to the fan control circuit.</li> <li>• Hydraulic reservoir—this contains the hydraulic fluid supply.</li> <li>• Hydraulic filter—this filters the hydraulic fluid.</li> <li>• Hydraulic heat exchanger—this cools the hydraulic fluid.</li> <li>• Hydraulic temperature sensor—this measures the hydraulic fluid temperature.</li> <li>• Hydraulic temperature switch—this activates the fan control circuit.</li> <li>• Hydraulic level sensor—this monitors the hydraulic fluid level in the reservoir.</li> <li>• Fan control circuit—this provides power to the heat exchanger fan.</li> <li>• Loop flush manifold—this draws hot hydraulic fluid from the main hydraulic lines and sends it to the heat exchanger.</li> <li>• Bypass valve—this allows hydraulic fluid to flow into the filter or sends it back to the heat exchanger.</li> <li>• Concentrate discharge pressure transducer—this measures the pressure in the concentrate line.</li> <li>• Pressure relief valve—this limits the pressure in the concentrate discharge manifold by opening when the pressure reaches a predetermined level.</li> </ul>
5 Concentrate supply	<p>This contains components that hold or supply foam concentrate for the system. The components in this subsystem include:</p> <ul style="list-style-type: none"> <li>• Concentrate supply tank—this contains the on-board foam concentrate supply.</li> <li>• Tank-full sensor—this indicates a tank full condition to the system.</li> <li>• Tank-low sensor—this indicates a tank low condition to the system.</li> <li>• Tank level sensor—this is an installer-supplied sensor and display that indicates the supply level in the tank.</li> <li>• Concentrate pump intake select valve—this is an installer-supplied, 2-position valve and additional components that source concentrate from an on-board tank or an auxiliary supply. A signal is provided to the system to ignore the on-board tank sensors when sourcing concentrate from an auxiliary supply.</li> <li>• Concentrate strainer—this collects debris that would otherwise flow through the system and potentially damage the concentrate pump.</li> </ul>



## Aquis UltraFlow Industrial Foam Proportioner System

Subsystem	Description
6 Concentrate supply refill line	<p>This allows you to fill the on-board tank from an external source. The components in this subsystem include:</p> <ul style="list-style-type: none"> <li>• Node controller—this connects to the fill valve and flowmeters.</li> <li>• Fill line control valve—this controls the concentrate flow.</li> <li>• Magnetic flowmeter—this measures the concentrate flow.</li> <li>• CAN cable splitter—this connects the node controllers to one another and the control box.</li> <li>• Check valve—this prevents reverse fluid flow in the line.</li> </ul>
7 Low-flow bypass line	<p>This returns a portion of the concentrate in the supply line back to the pump inlet when the desired concentrate output requires the pump to operate at an rpm that is lower than its capabilities. The components in this subsystem include:</p> <ul style="list-style-type: none"> <li>• Node controller—this connects to the low-flow control valve and flowmeters.</li> <li>• Low-flow valve—this controls the concentrate return flow.</li> <li>• Magnetic flowmeter—this measures the concentrate flow.</li> <li>• CAN cable splitter—this connects the node controllers to one another.</li> </ul>
8 Transfer line	<p>This allows you to transfer or relay concentrate from the apparatus to another location. The components in this subsystem include:</p> <ul style="list-style-type: none"> <li>• Node controller—this connects to and controls the concentrate control valve and flowmeters.</li> <li>• CAN cable splitter—this connects the node controllers to one another and the control box.</li> <li>• Concentrate control valve—this controls the concentrate flow.</li> <li>• Magnetic flowmeter—this measures the concentrate flow.</li> <li>• Check valve—this prevents reverse fluid flow in the line.</li> </ul>
9 Priming line	<p>This evacuates air from the concentrate pump inlet as the system primes before operation. The components in this subsystem include:</p> <ul style="list-style-type: none"> <li>• Priming valve—this opens to allow air to evacuate the line before operation.</li> <li>• CAN cable splitter—this connects the node controllers to one another and the control box.</li> <li>• Prime bypass valve—this is an installer-supplied valve that prevents contaminating the concentrate during training. When water is substituted for concentrate during training or testing, and there is concentrate in the supply tank, this bypass valve prevents water from contaminating the concentrate supply.</li> </ul> <p><b>Note:</b> You must drain any remaining water in the line before priming the system with concentrate to prevent contamination.</p>

## Hydraulic Components

The hydraulic system powers the foam concentrate pump. Apparatus power circulates hydraulic fluid from the reservoir, through the hydraulic motor in order to power the concentrate pump, through the heat exchanger and filter, then back to the reservoir.

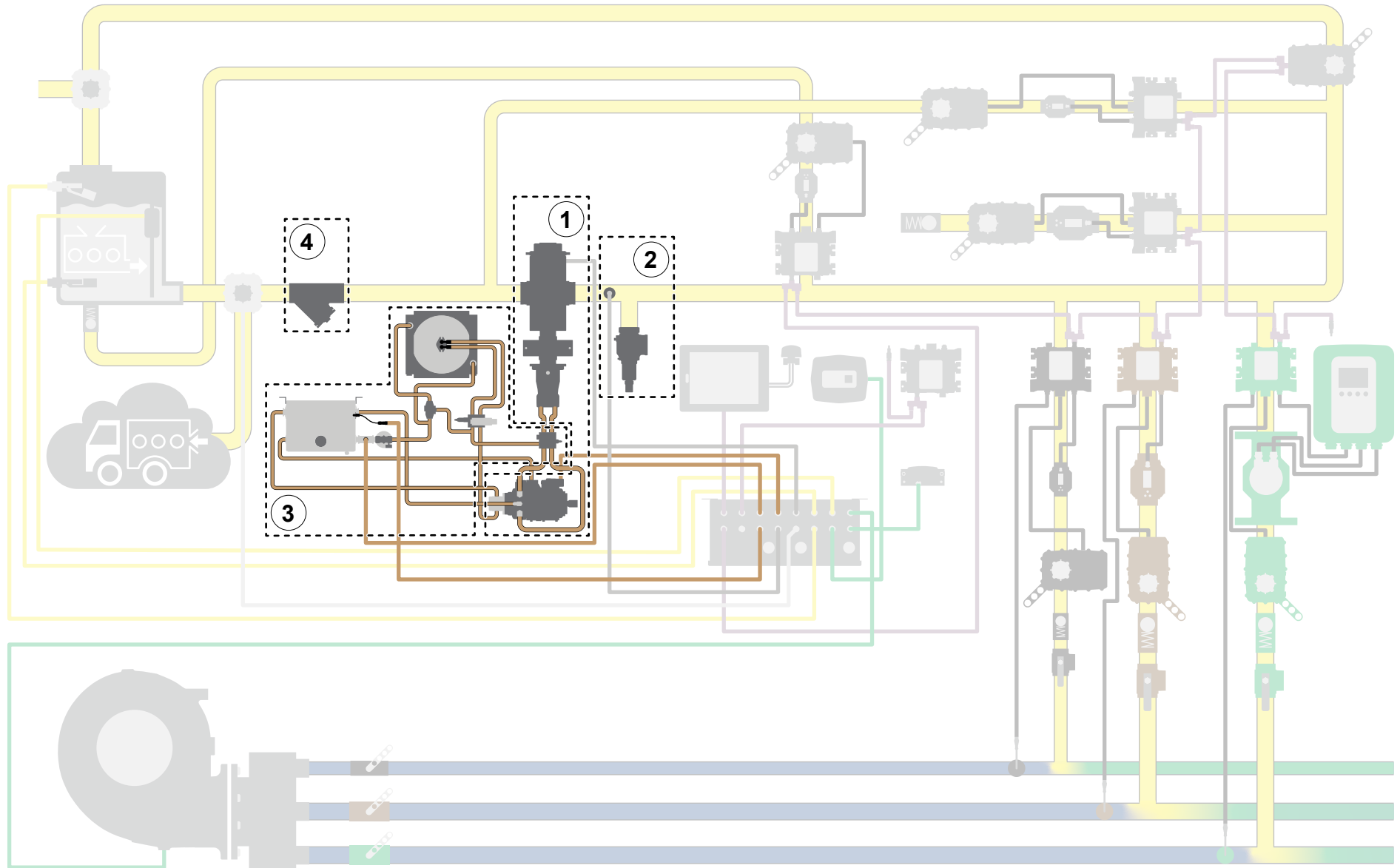

## Hydraulic Components

---

Subsystem	Description
1 Concentrate pump components	This transports the concentrate through the system. It includes the concentrate pump, hydraulic motor, and hydraulic pump.
2 Pressure components	This measures and manages the pressure in the concentrate line. It includes the pressure transducer and pressure relief valve.
3 Hydraulic fluid components	This contains and manages the hydraulic fluid. It includes the hydraulic reservoir, hydraulic filter, hydraulic heat exchanger, fan control circuit, loop flush manifold, and bypass valve.
4 Concentrate strainer	This collects debris that would otherwise flow through the system and potentially damage the concentrate pump.

## Concentrate Pump Assembly

The concentrate pump assembly includes the concentrate pump and a flange to mount the hydraulic motor.

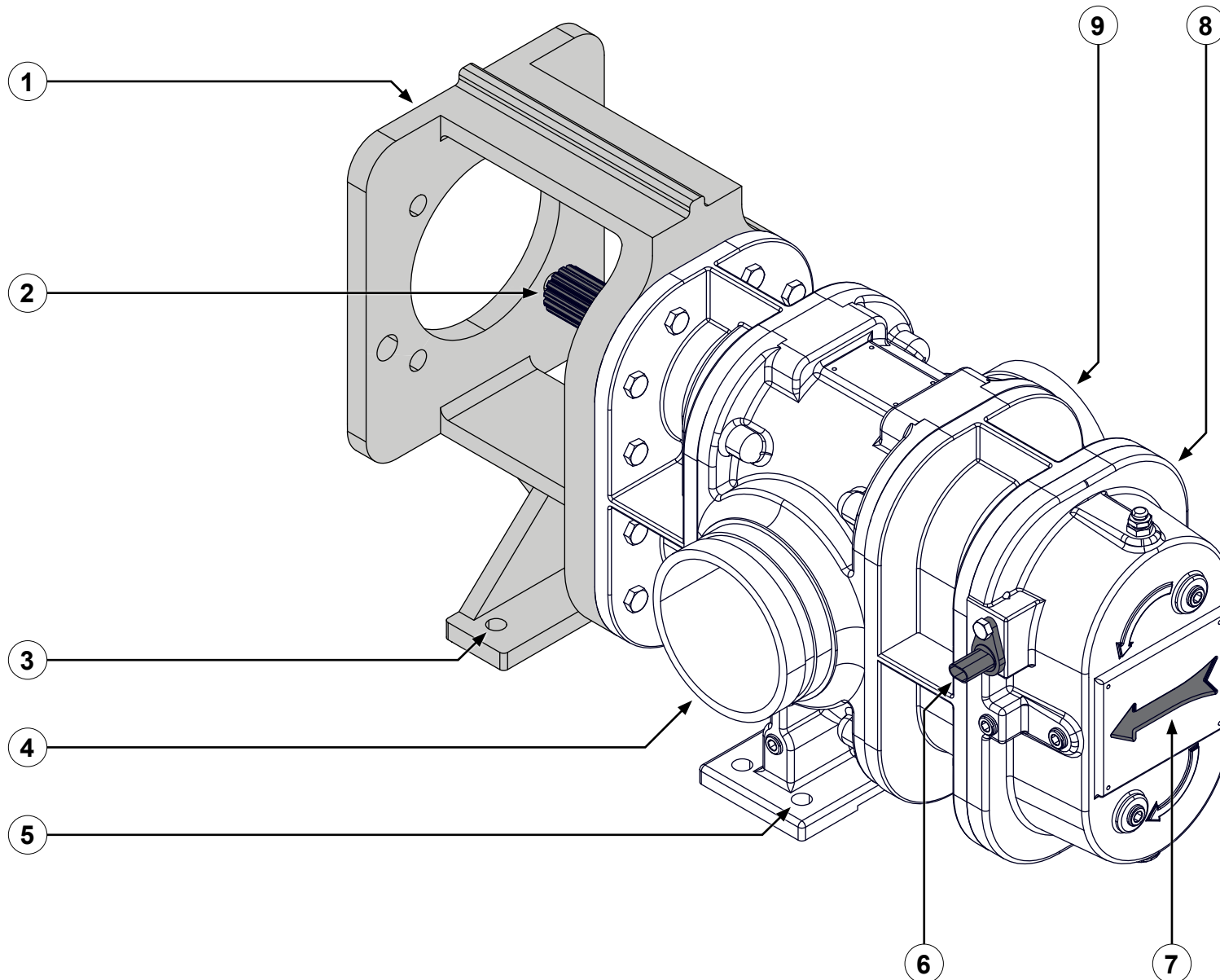

## Concentrate Pump Assembly

---

Feature	Description
1 Motor mount flange	This allows the hydraulic motor to be mounted on the concentrate pump.
2 Concentrate pump drive shaft	This drives the concentrate pump—SAE D, 1-3/4-13T 8/16 spline.
3 Flange mounting holes	These mount the motor mount flange on the apparatus.
4 Concentrate outlet	This is where the concentrate exits the pump—5-inch Victaulic®.
5 Concentrate pump mounting holes	These mount the pump on the apparatus.
6 Speed sensor connector	This connects to the concentrate pump cable, which connects to the control box.
7 Flow indicator	This indicates the direction of flow.
8 Concentrate pump	This pressurizes the concentrate in the concentrate discharge manifold.
9 Concentrate inlet	This is where the concentrate enters the pump—5-inch Victaulic.

## Spider Coupler

The coupler connects the concentrate pump shaft to the hydraulic motor shaft.

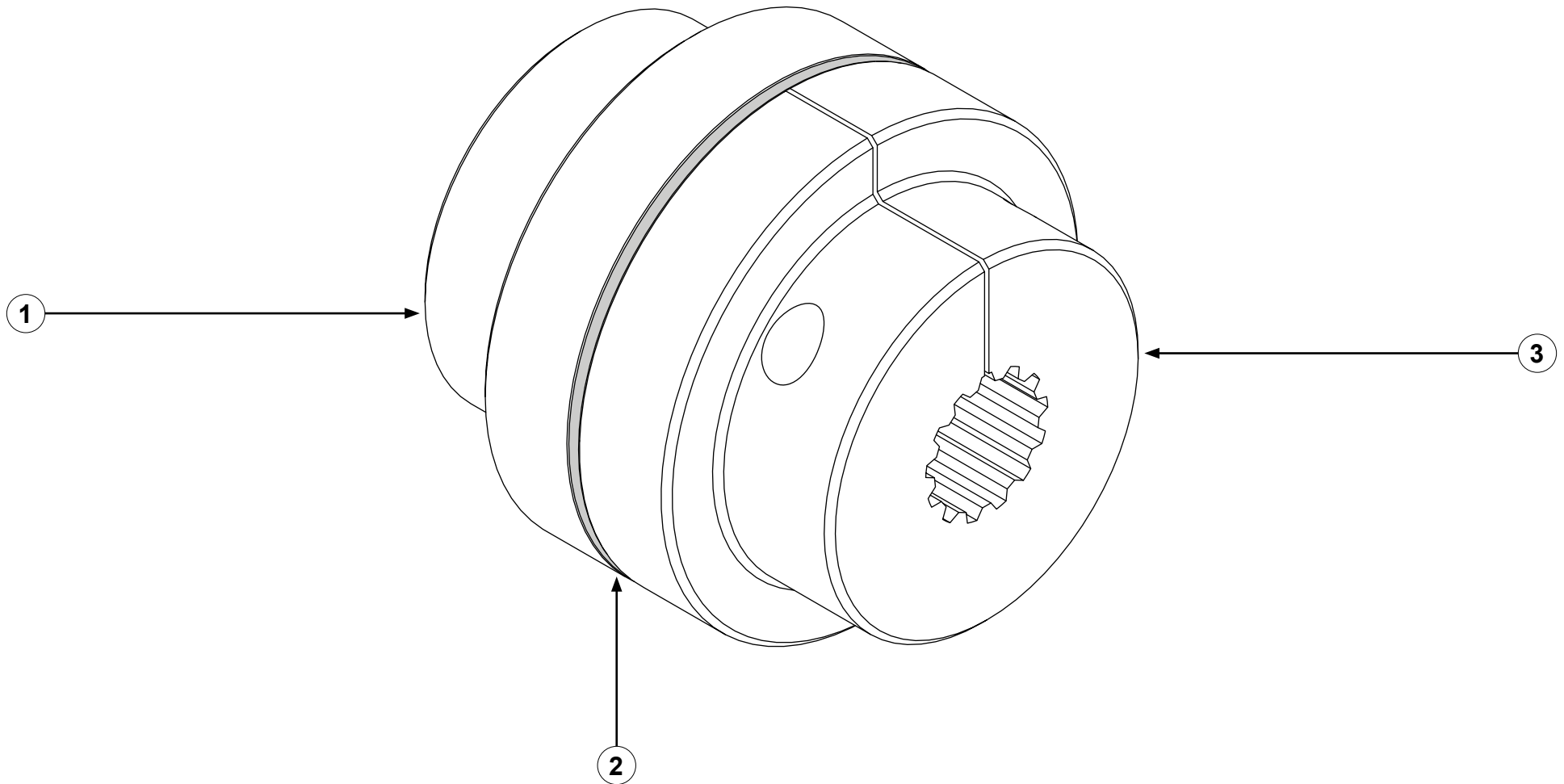

## Spider Coupler

---

Feature	Description
1 Motor hub	This connects to the concentrate pump. <b>Note:</b> <i>The motor hub and pump hub are interchangeable.</i>
2 Elastomer spider	This transfers torque between the hubs.
3 Pump hub	This connects to the hydraulic motor. <b>Note:</b> <i>The pump hub and motor hub are interchangeable.</i>

## Hydraulic Motor

The hydraulic motor is controlled by the hydraulic pump and drives the concentrate pump.

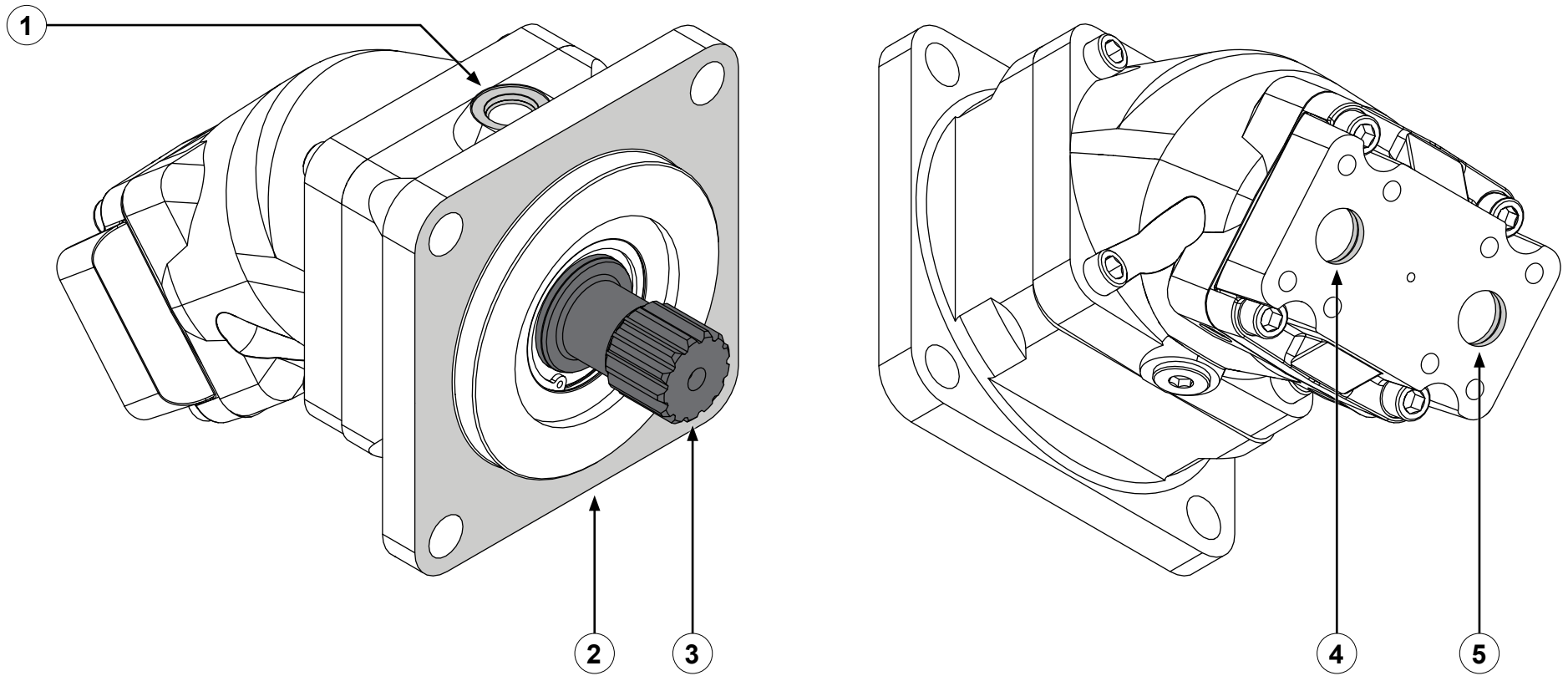



## Hydraulic Motor

---

Feature	Description
1 Hydraulic outlet	This connects to the hydraulic pump—1/2 BSPP. An additional outlet is located on the opposite side of the motor. Always connect to the lower outlet.
2 Mounting flange	This allows the motor to be mounted on the concentrate pump motor mount flange.
3 Hydraulic motor shaft	This connects to the concentrate pump—13T 8/16 spline.
4 A-port	This connects to the A1-port on the loop flush manifold—SAE J518, 1-inch, code 62, 4-bolt split flange.
5 B-port	This connects to the B1-port on the loop flush manifold—SAE J518, 1-inch, code 62, 4-bolt split flange.

## Hydraulic Pump

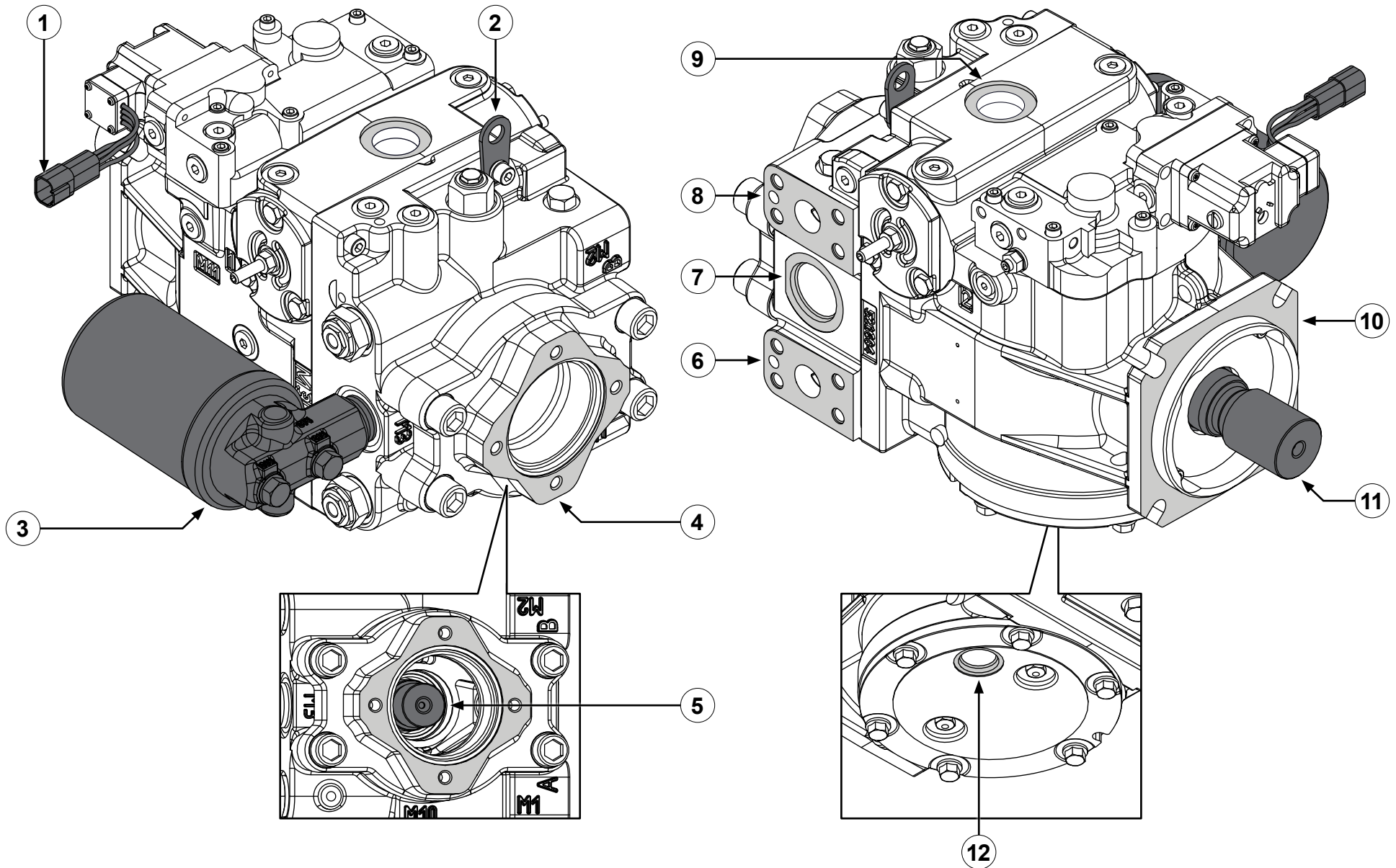

## Hydraulic Pump

Feature	Description
1 Swashplate connector	This connects to the hydraulic pump cable, which connects to the control box.
2 Lift point	This assists in lifting the pump.
3 Hydraulic filter	This filters the hydraulic fluid.
4 Fan pump mounting pad	This is where the hydraulic fan pump is mounted on the hydraulic pump.
5 Auxiliary coupling shaft	This drives the hydraulic fan pump—SAE AB, 2-bolt, 1-inch 15T 16/32 spline.
6 A-port outlet	This connects to the A2-port on the loop flush manifold—1-inch, split flange, SAE J518, code 62.
7 S-port inlet	This supplies hydraulic fluid from the reservoir—1-5/8-12 UN-2B.
8 B-port outlet	This connects to the B2-port on the loop flush manifold—1-inch, split flange, SAE J518, code 62.
9 L1 case drain port	This returns hydraulic fluid that is providing internal lubrication to the reservoir—1-1/16-12 UN-2B, O-ring boss, SAE J514, code 62.
10 Pump mount	This allows the hydraulic pump to be mounted on the apparatus.
11 Input shaft	This connects to the apparatus and drives the hydraulic pump—13T 8/16 spline.
12 L2 case drain port	This returns hydraulic fluid from the motor casing to the reservoir—1-1/16-12 UN-2B, O-ring boss, SAE J514, code 62.

## Hydraulic Fan Pump

The hydraulic fan pump provides power to the fan control circuit.

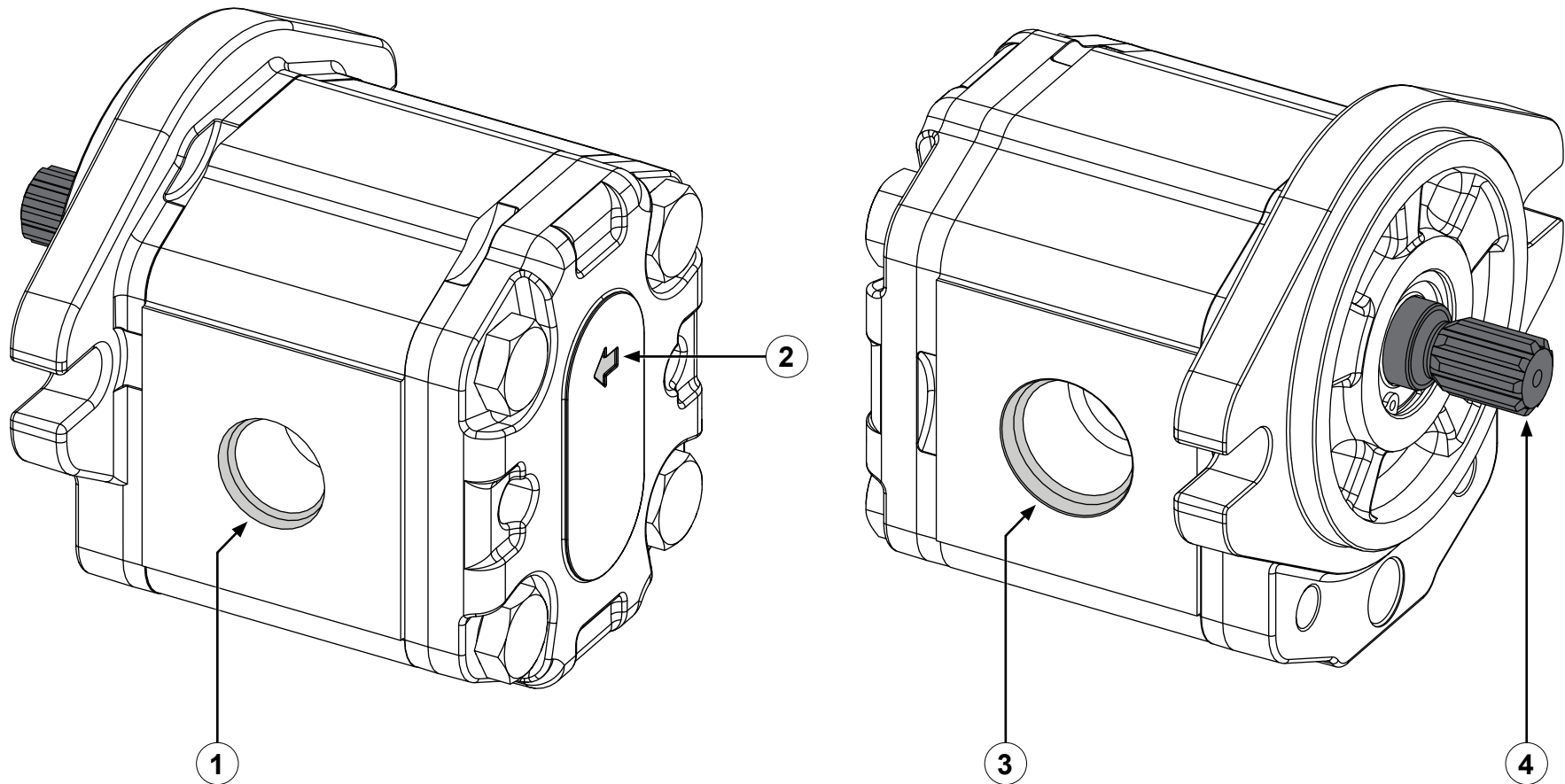

## Hydraulic Fan Pump

---

Feature	Description
1 Fan control outlet	This connects to the P-port on the fan control circuit—1-1/16-12 UN.
2 Flow indicator	This indicates the direction of flow.
3 Hydraulic inlet	This connects to the reservoir strainer—7/8-14 UNF.
4 Input shaft	This is driven by the hydraulic pump coupling shaft—SAE J498-9T 16/32 spline.

## Hydraulic Heat Exchanger

The hydraulic heat exchanger manages the hydraulic fluid temperature.

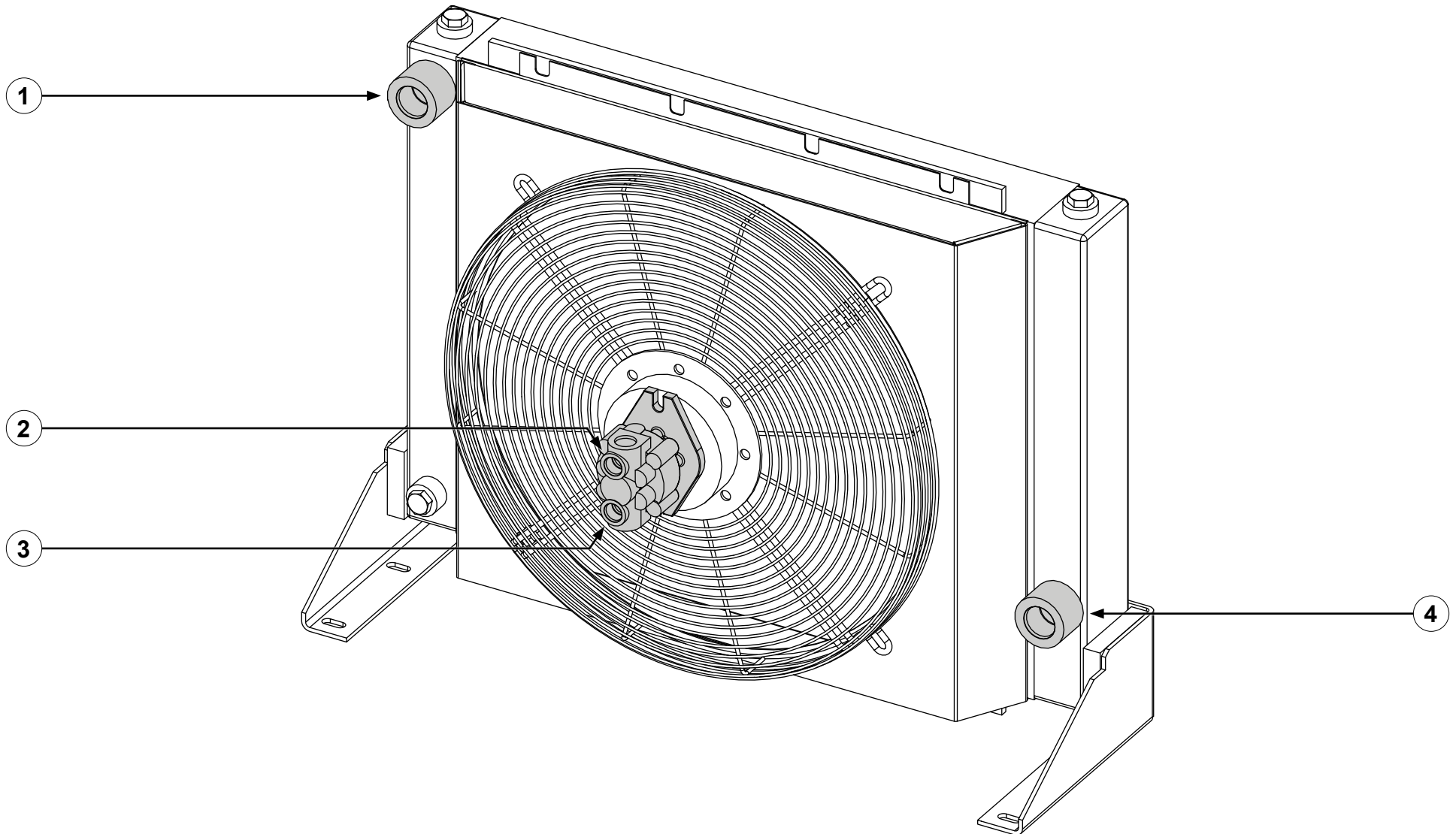

## Hydraulic Heat Exchanger

---

Feature	Description
1 Hydraulic inlet	This is where the hydraulic fluid enters the heat exchanger—#16 SAE.
2 A-port	This connects to the B-port on the fan control circuit.
3 B-port	This connects to the A-port on the fan control circuit.
4 Hydraulic outlet	This is where the hydraulic fluid exits the heat exchanger—#16 SAE.

## Fan Control Circuit

The fan control circuit provides power to the heat exchanger fan.

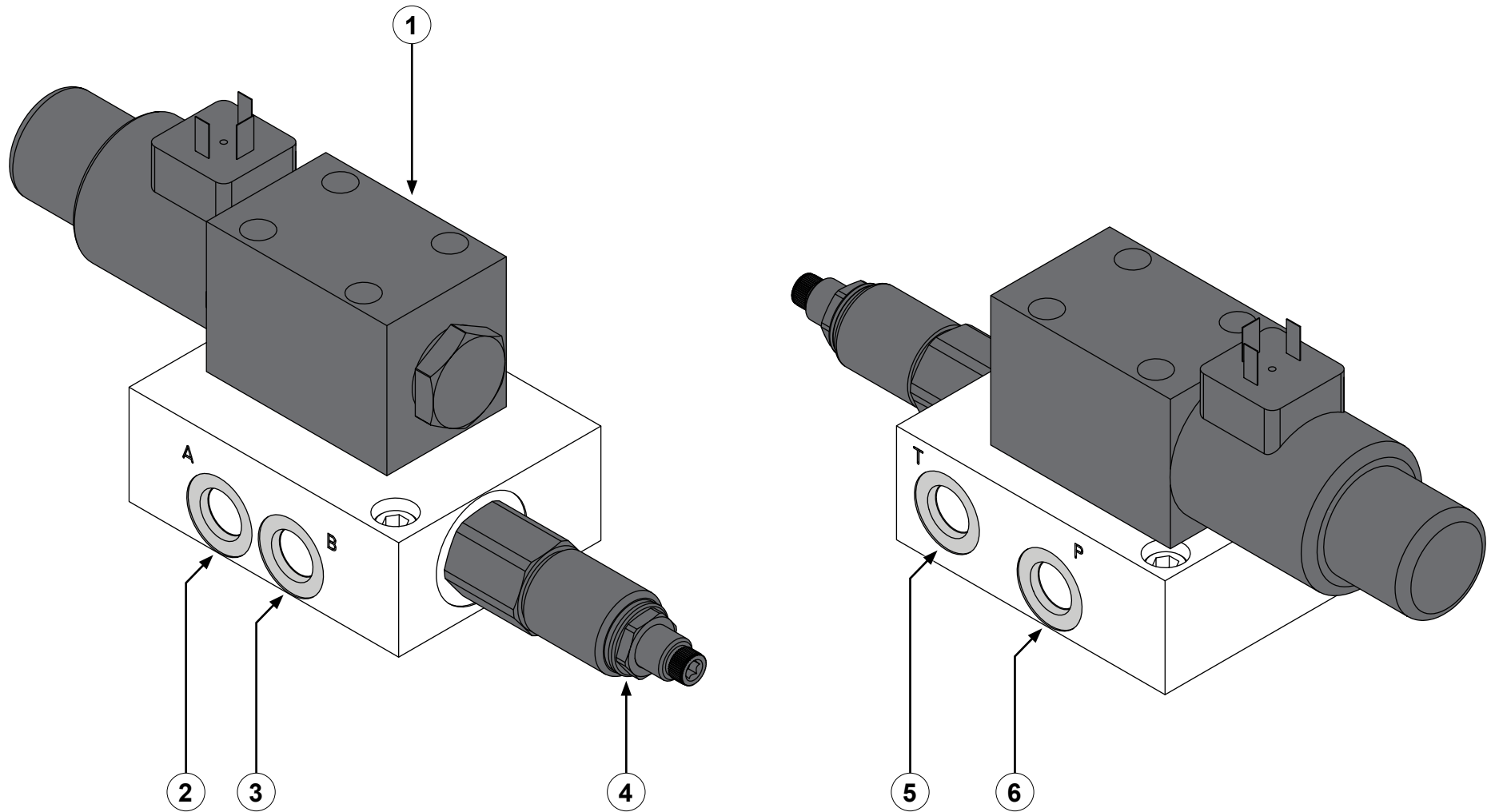



## Fan Control Circuit

---

Feature	Description
1 Solenoid directional valve	This controls the fan motor.
2 A-port	This connects to the B-port on the fan motor—9/16-16, O-ring face.
3 B-port	This connects to the A-port on the fan motor—9/16-16, O-ring face.
4 Relief valve	This controls the pressure in the system.
5 T-port	This connects to the bypass valve inlet—9/16-16, O-ring face.
6 P-port	This connects to the fan pump outlet—9/16-16, O-ring face.

## Loop Flush Manifold

The loop flush manifold draws hot hydraulic fluid from the main hydraulic lines and sends it to the heat exchanger.

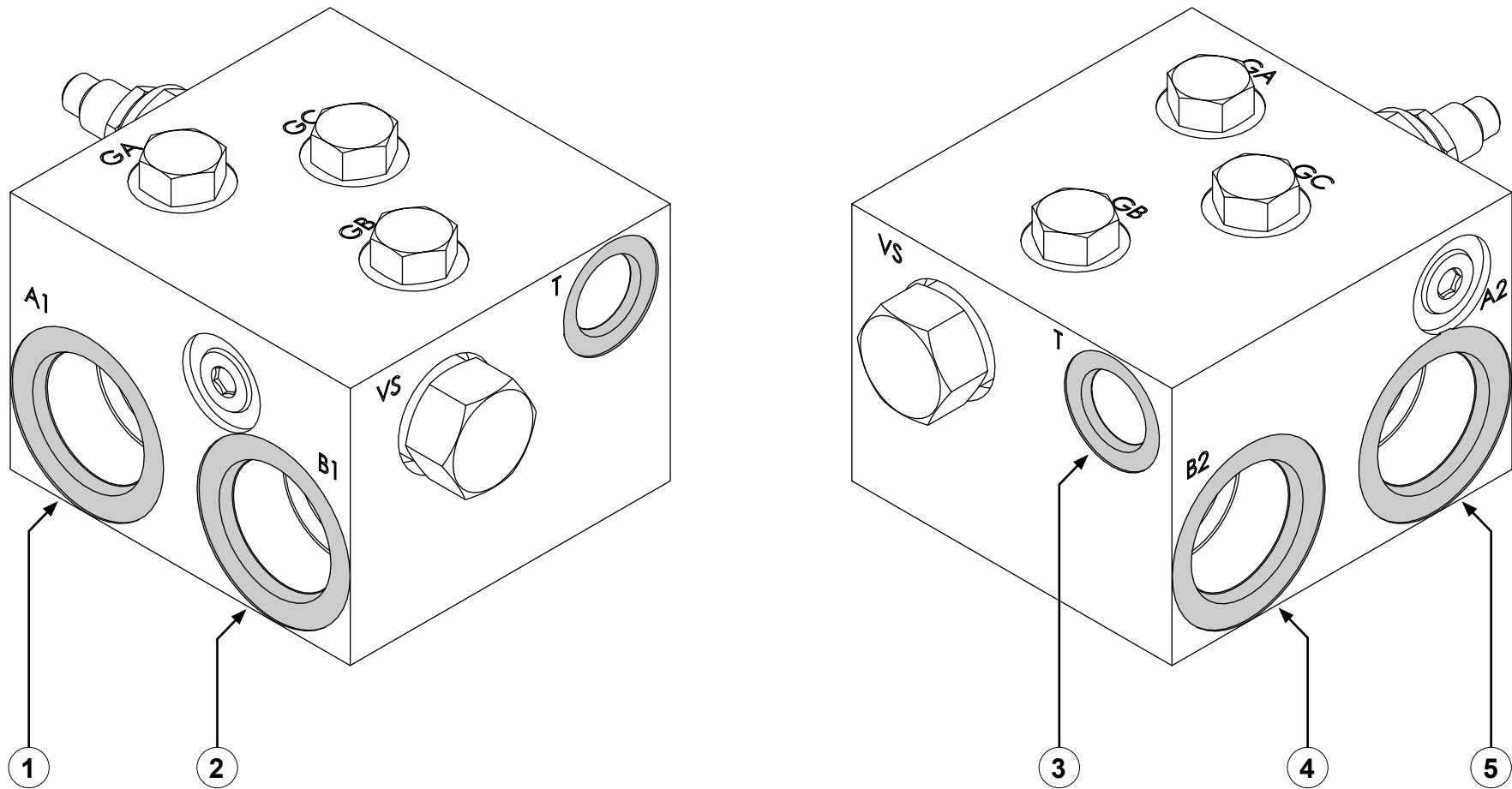

## Loop Flush Manifold

---

Feature	Description
1 A1-port	This connects to the A-port on the hydraulic motor—#16 SAE.
2 B1-port	This connects to the B-port on the hydraulic motor—#16 SAE.
3 T-port	This connects to the bypass valve—#8 SAE.
4 A2-port	This connects to the A-port on the hydraulic pump—#16 SAE.
5 B2-port	This connects to the B-port on the hydraulic pump—#16 SAE.

## Bypass Valve

The bypass valve allows hydraulic fluid to flow into the filter or sends it back to the heat exchanger.

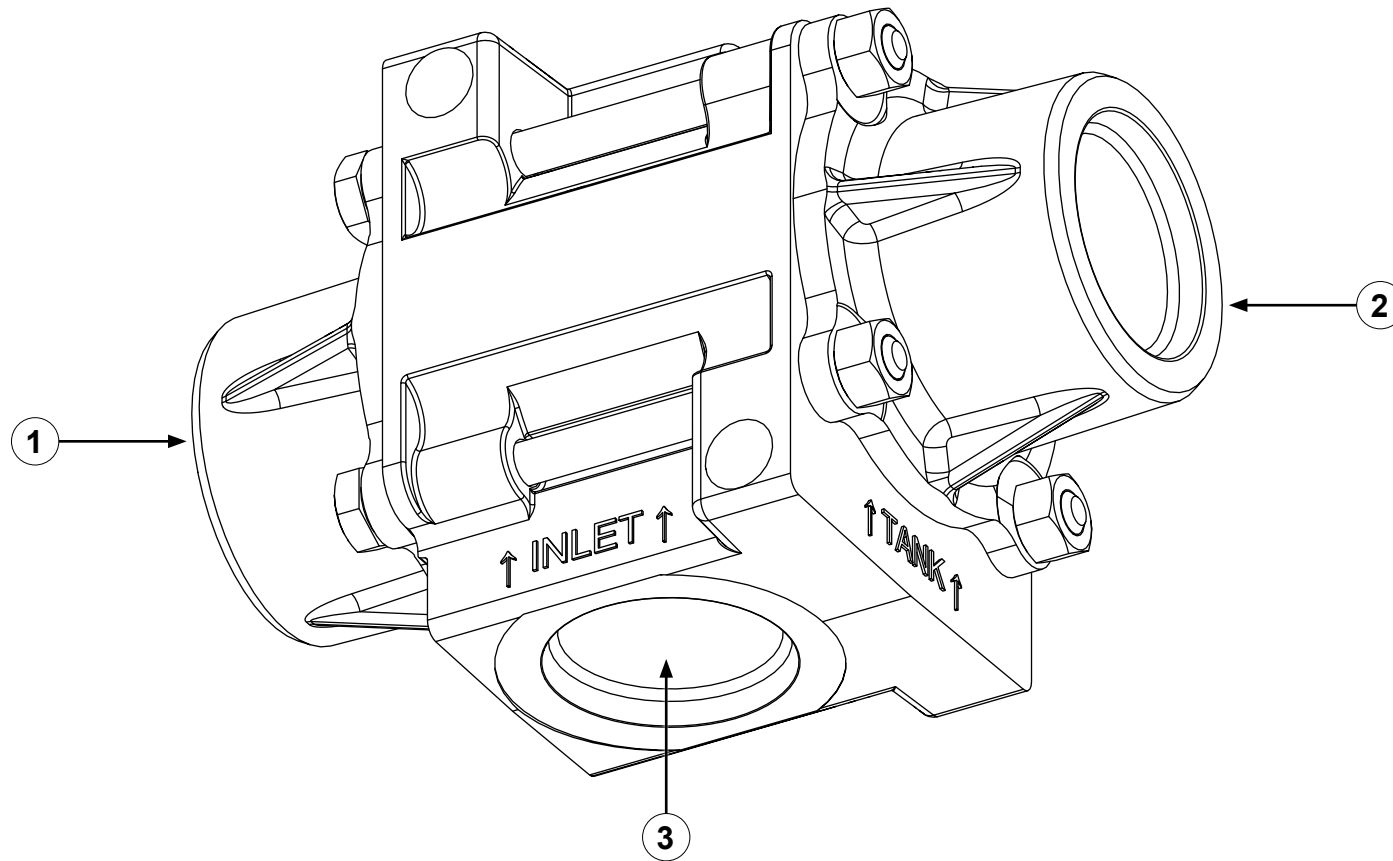

## Bypass Valve

---

Feature	Description
1 Heat exchanger port	This connects to the hydraulic inlet on the heat exchanger—#16 SAE.
2 Tank port	This connects to the inlet on the hydraulic filter—#16 SAE.
3 Inlet	This connects to the T-port on the fan control circuit—#16 SAE.

## Hydraulic Reservoir

The reservoir holds the hydraulic fluid supply. The ports on the reservoir are mirrored and interchangeable to suit your application.

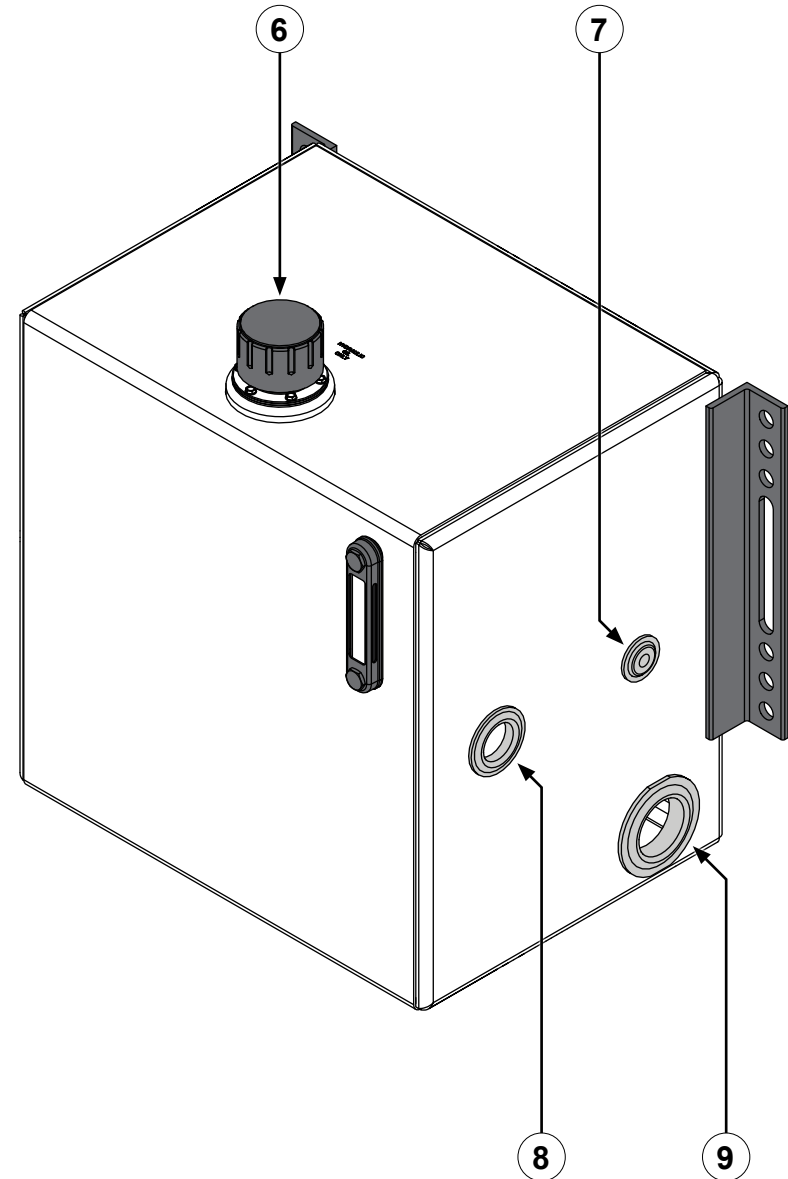
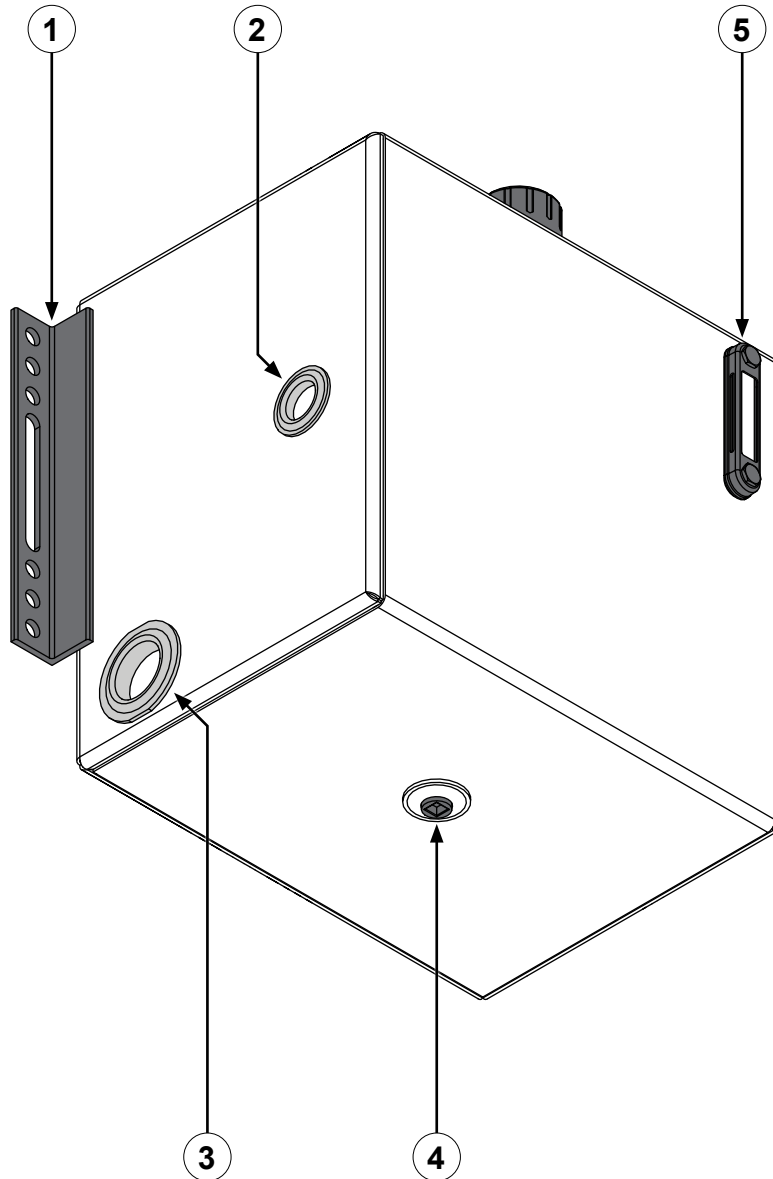

## Hydraulic Reservoir

---

Feature	Description
1 Mounting brackets	These mount the hydraulic reservoir on the apparatus.
2 Left side upper port	This port connects to the hydraulic pump in typical applications—1-1/4 NPT.
3 Left side lower port	This connects to the hydraulic fan pump inlet in typical applications. A strainer is installed directly into the port.
4 Magnetic drain port	This is where hydraulic fluid is drained from the reservoir. It contains a magnet to collect metal partials.
5 Sight gauge	This shows the hydraulic fluid level in the reservoir.
6 Fill port	This is where hydraulic fluid is added to the reservoir.
7 Accessory port	This is where the level sensor is installed into the reservoir—1/4 NPT.
8 Right side upper port	This port connects to the filter, temperature sensor, and temperature switch in typical applications—1-1/4 NPT.
9 Right side lower port	This connects to the hydraulic pump in typical applications. A strainer is installed directly into the port.

## Hydraulic Level Sensor

The level sensor monitors the hydraulic fluid level in the reservoir.

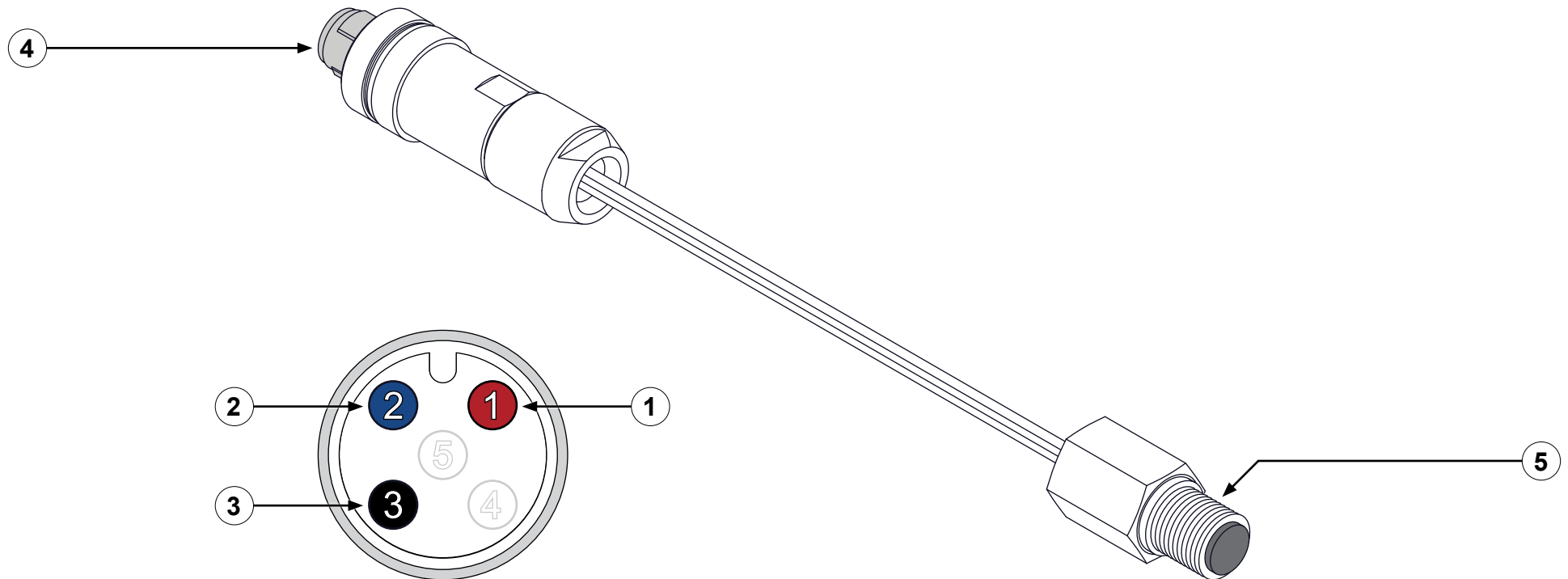



## Hydraulic Level Sensor

---

	Feature	Description
1	Red wire	Vcc, +12 V
2	Blue wire	Signal
3	Black wire	Ground
4	M12 connector	This connects to the control box through a sensor cable.
5	Optical sensor	This monitors the hydraulic fluid level—1/4 NPT.

## Hydraulic Temperature Sensor

The temperature sensor measures the hydraulic fluid temperature in the reservoir.

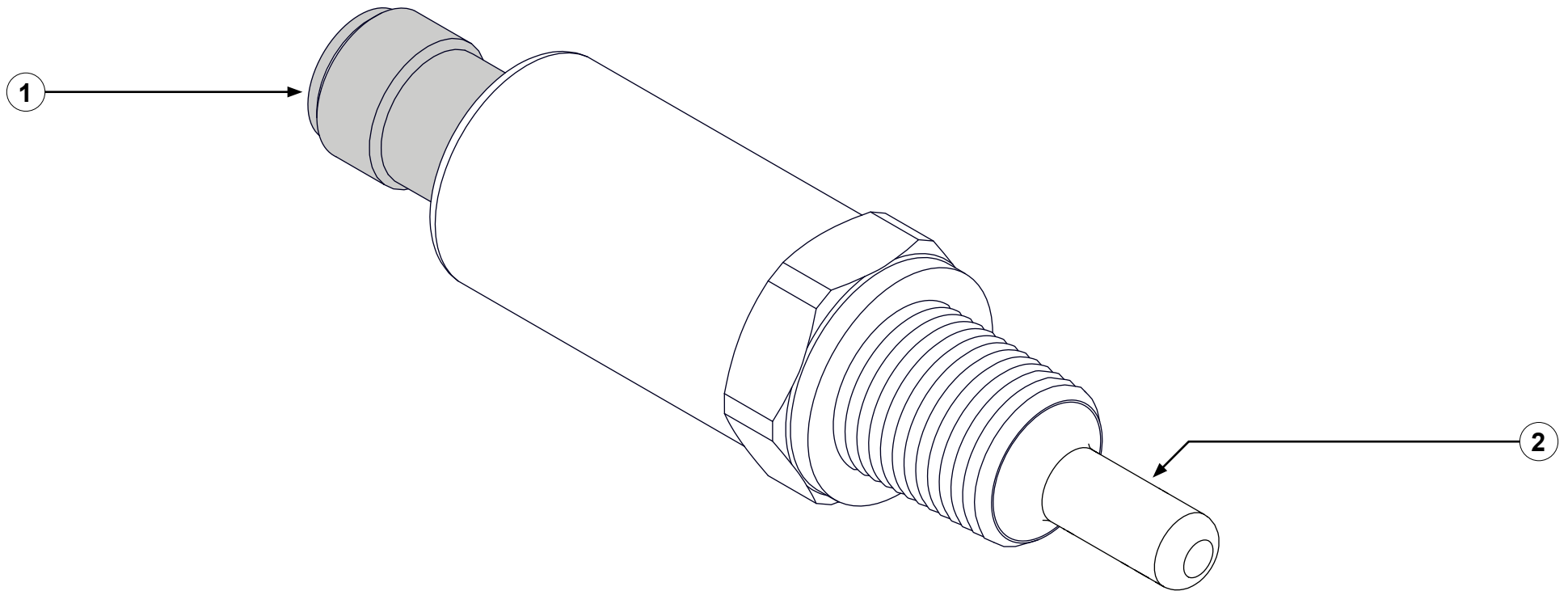

## Hydraulic Temperature Sensor

---

Feature	Description
1 M12 connector	This connects to the control box through a sensor cable.
2 Temperature probe	This measures the hydraulic fluid temperature—1/4 NPT.

## Hydraulic Temperature Switch

The temperature switch operates the circuit that controls the heat exchanger.

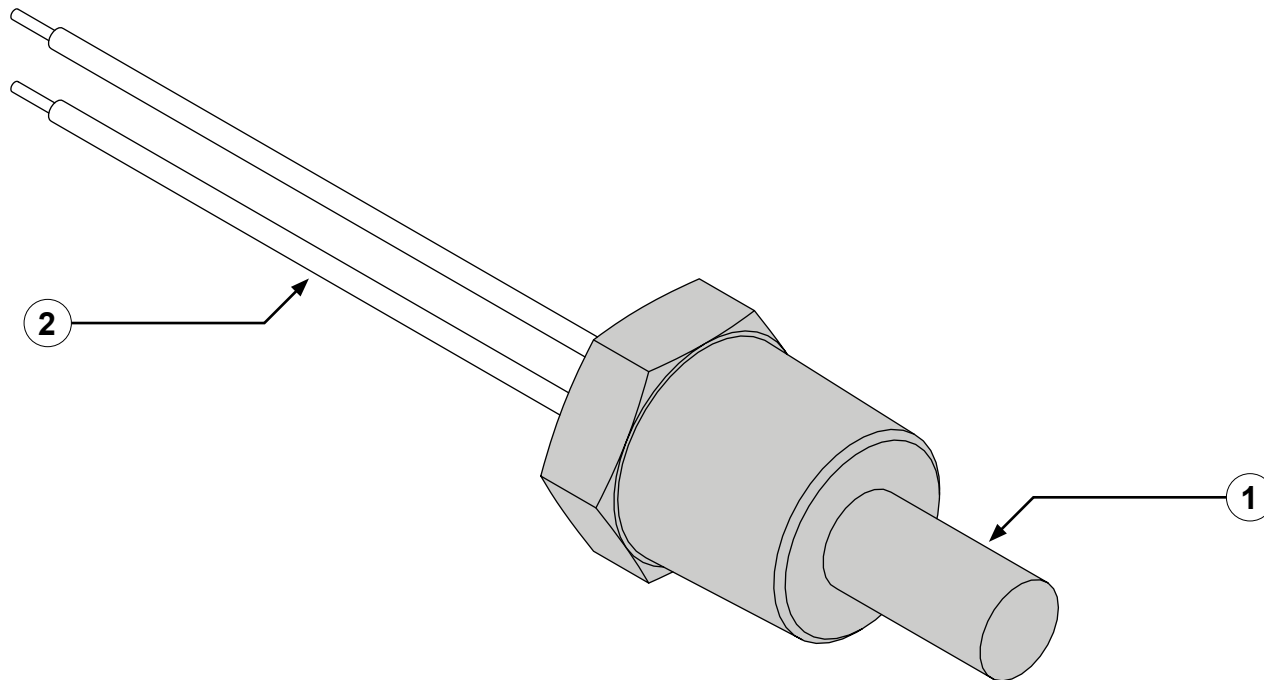

## Hydraulic Temperature Switch

---

Feature	Description
1 Temperature probe	This measures the hydraulic fluid temperature—1/2 NPT.
2 Wire leads	These connect to a solenoid and power. <b>Note:</b> <i>The wire leads are non-polarized and either wire can be connected to the solenoid or power.</i>

## Hydraulic Suction Strainer

The suction strainer filters debris from the hydraulic fluid before it exits the reservoir.

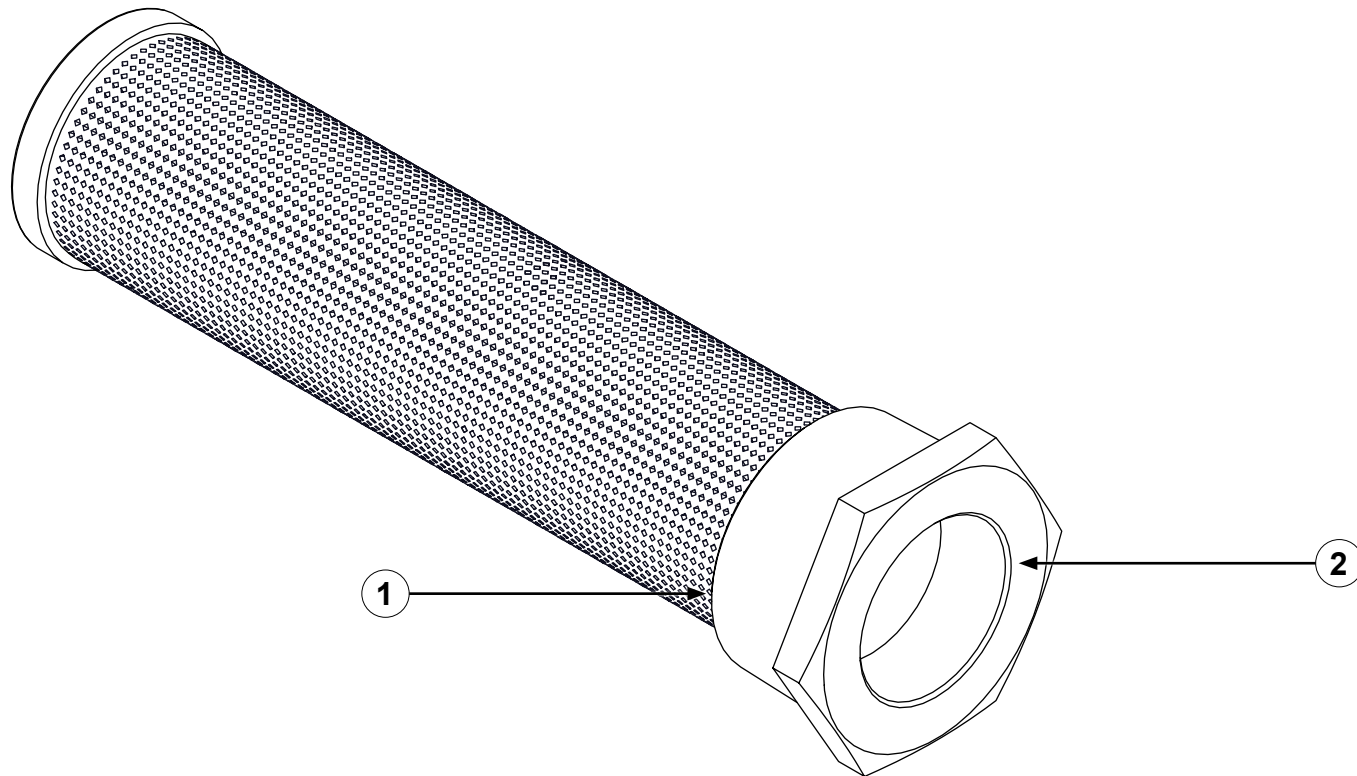

## Hydraulic Suction Strainer

---

Feature	Description
1 Strainer body	This filters debris from the hydraulic fluid—1-1/4 NPT thread.
2 Outlet	This is where the outlet fitting threads into the strainer—3/4 NPT thread.

## Hydraulic Filter Components

The hydraulic filter assembly filters the hydraulic fluid and contains the filter head, filter, and filter indicator.

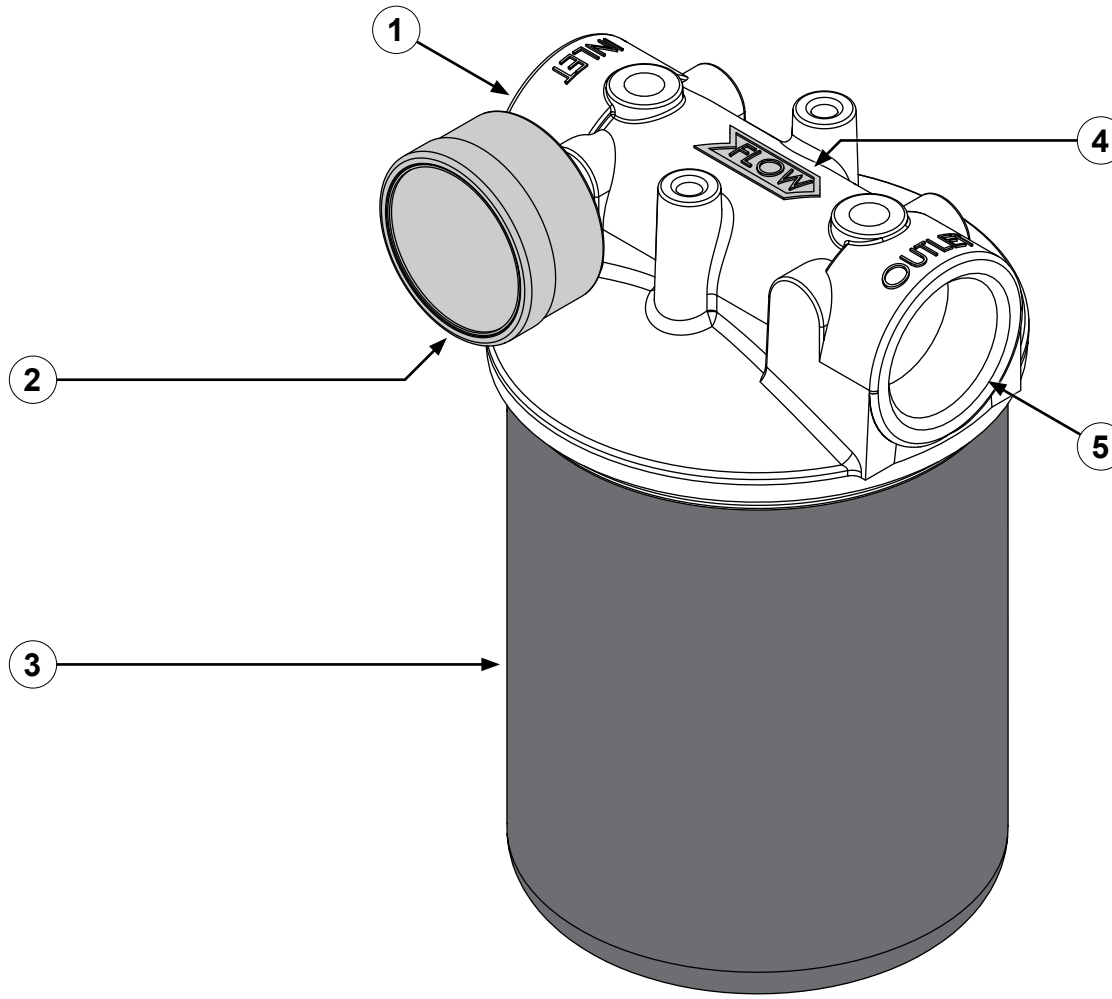



## Hydraulic Filter Components

---

Feature	Description
1 Filter head inlet	This is the inlet for the hydraulic fluid—1-1/4 NPT.
2 Filter indicator	This indicates the filter condition.
3 Filter	This filters the hydraulic fluid.
4 Flow indicator	This indicates the direction of flow.
5 Filter head outlet	This is the outlet for the hydraulic fluid—1-1/4 NPT.

## Concentrate Strainer

The concentrate strainer collects debris that would otherwise flow into the system and potentially damage the concentrate pump.

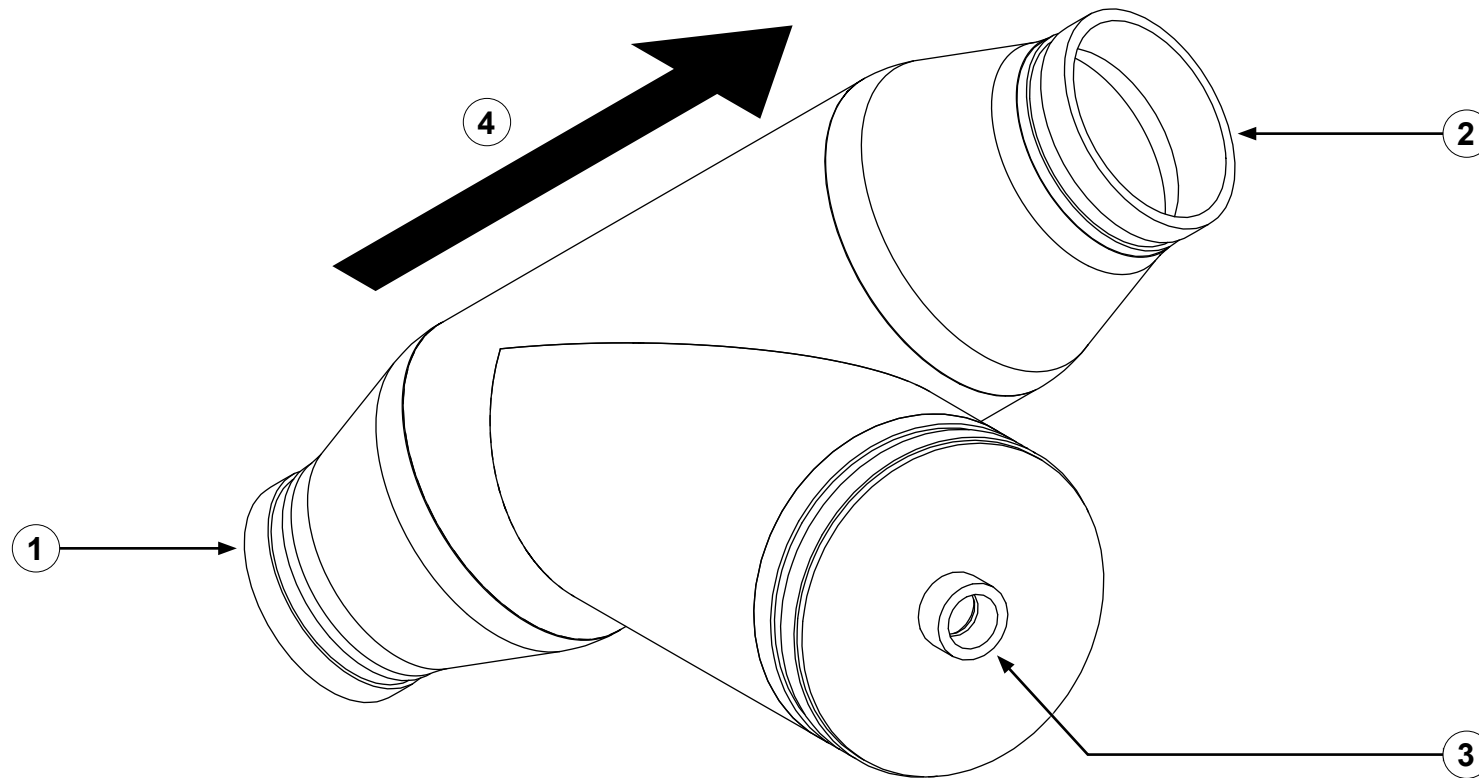

## Concentrate Strainer

---

Feature	Description
1 Inlet	This is where the concentrate enters the strainer.
2 Outlet	This is where the concentrate exits the strainer.
3 Drain valve port	This allows a drain valve to be installed into the strainer—3/4 NPT.
4 Flow direction	This is the direction of flow.

## Pressure Relief Valve

The pressure relief valve limits the pressure in the concentrate discharge manifold by opening when the pressure reaches a predetermined level.

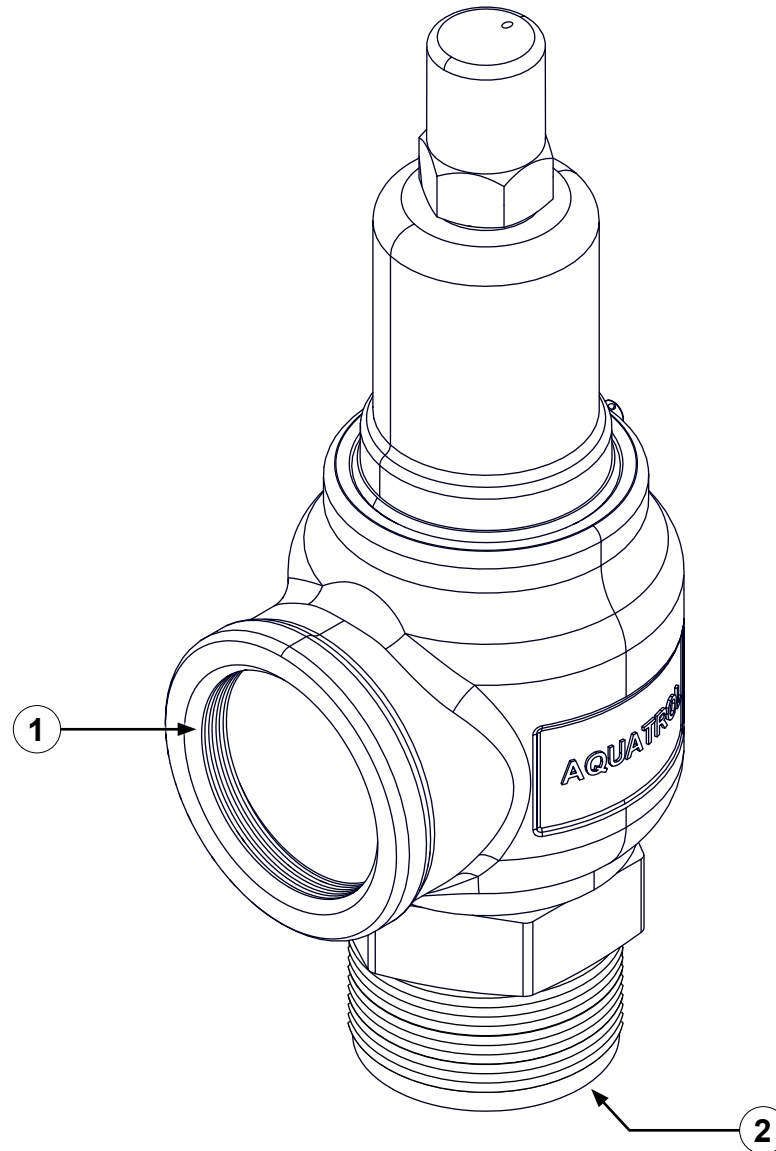

## Pressure Relief Valve

---

Feature	Description
1 Outlet	This is where the concentrate exits the pressure relief valve—2-1/2 NPT.
2 Inlet	This is where the concentrate enters the pressure relief valve—1-1/2 NPT.

## Pressure Transducer

The pressure transducer measures the pressure of different lines in the system.

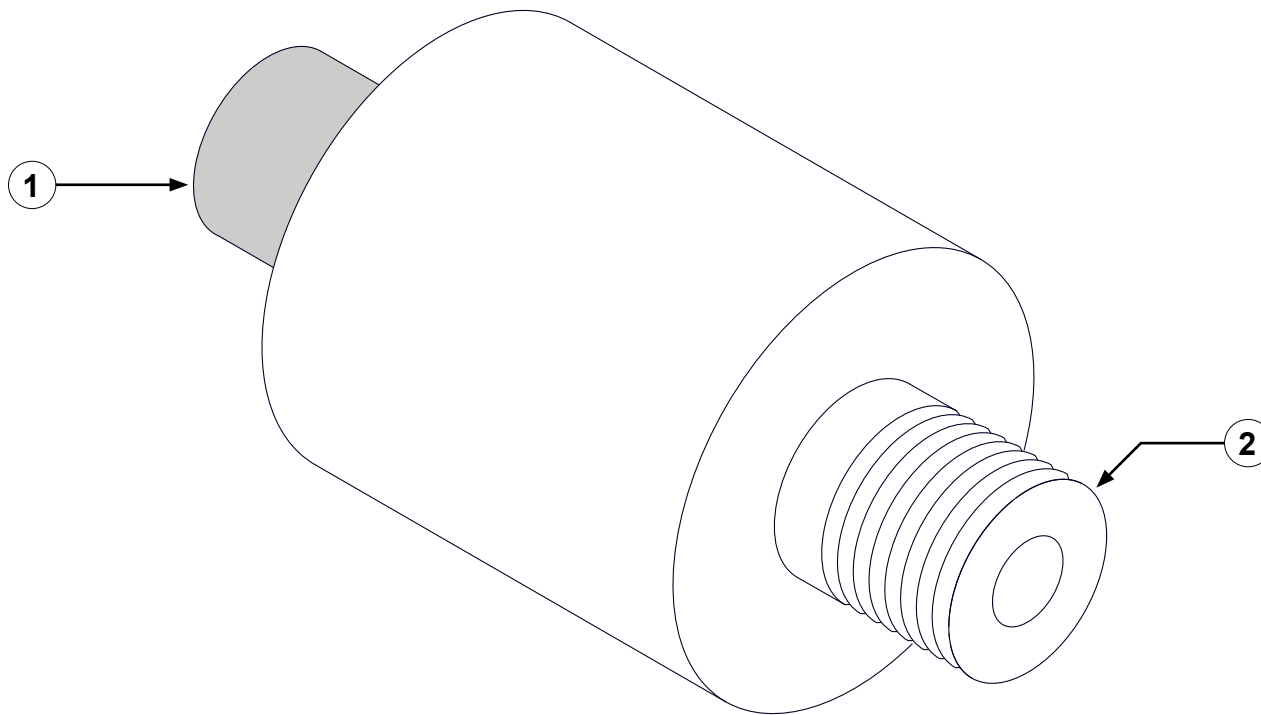

## Pressure Transducer

---

Feature	Description
1 M12 connector	This connects to the control box through a sensor cable or to the node controller Y-splitter when the water discharge pressure is unable to be measured at the pump.
2 Pressure transducer	This measures the pressure in the line—1/4 NPT, 0–500 psi.

### 3.0 Meter Sensor Cable

The sensor cable communicates data between the various connections. It is typically yellow, gray, or black. The sensor cable is not interchangeable with the CAN cable. You can connect 2 or more cables together to achieve a desired length.

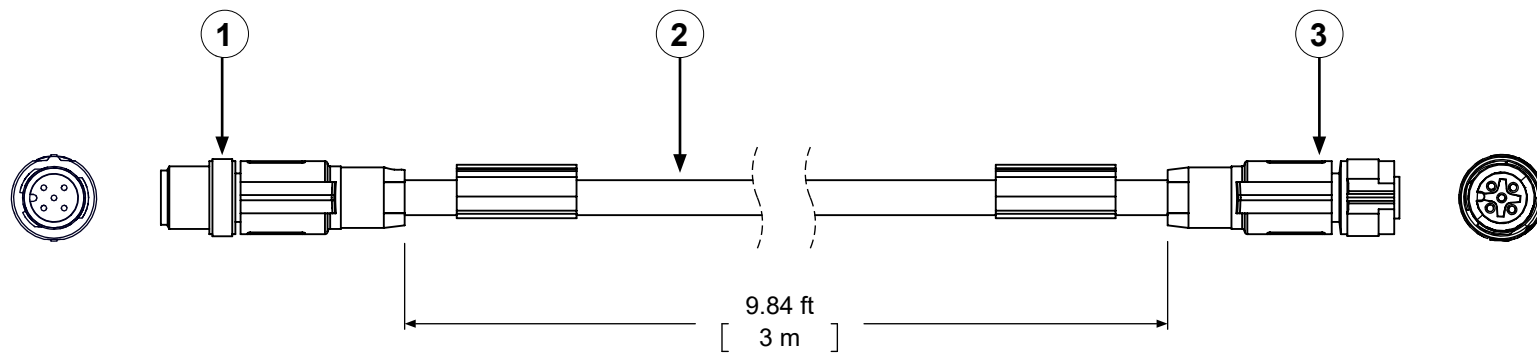

Feature	Description
1 M12 connector	This is a male connector.
2 Cable	This is typically a yellow, gray, or black cable jacket.
3 M12 connector	This is a female connector.



## 0.5 Meter Sensor Cable

The sensor cable communicates data between the various connections. It is typically yellow, gray, or black. The sensor cable is not interchangeable with the CAN cable. You can connect 2 or more cables together to achieve a desired length.

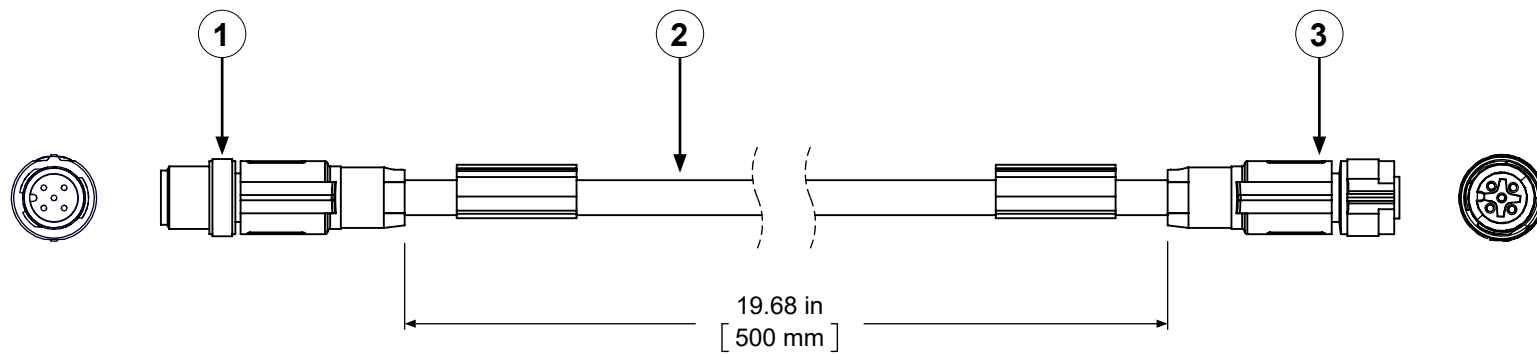

Feature	Description
1 M12 connector	This is a male connector.
2 Cable	This is typically a yellow, gray, or black cable jacket.
3 M12 connector	This is a female connector.

## Concentrate Pump Cable

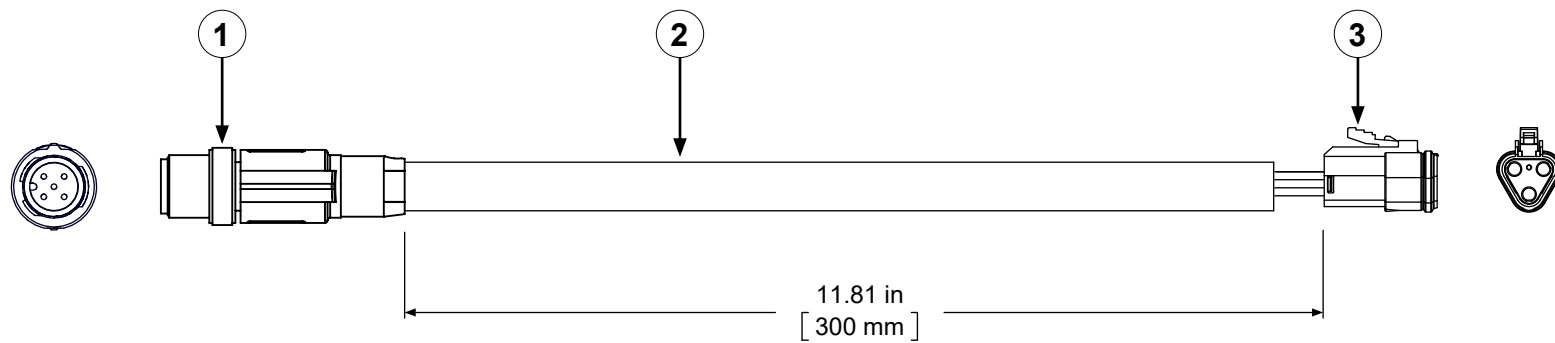

Feature	Description
1 M12 connector	This connects to the concentrate pump connector on the control box or a sensor cable connected to the control box.
2 Cable	This is a yellow cable jacket.
3 Connector	This connects to the speed sensor connector on the concentrate pump.

## Concentrate Pump Cable—Schematic

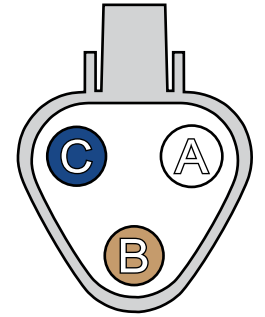
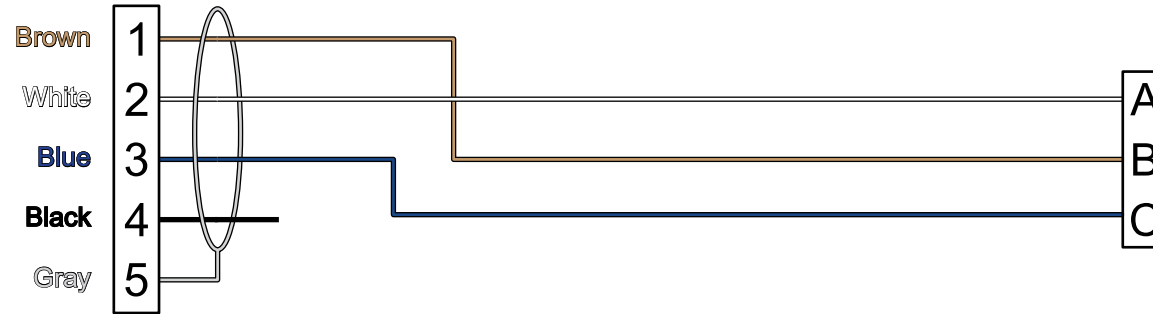

### M12 Connector

- |   |            |
|---|------------|
| 1 | Vcc, +24 V |
| 2 | Signal     |
| 3 | Ground     |
| 4 | N/C        |
| 5 | Shield     |

Phoenix Contact—1405879 or equivalent

### Connector

- |   |            |
|---|------------|
| A | Signal     |
| B | Vcc, +24 V |
| C | Ground     |

Shell—934452102 (1)

Wedge—934482003 (1)

Sockets—match to counterpart or equivalents

## Hydraulic Pump Cable

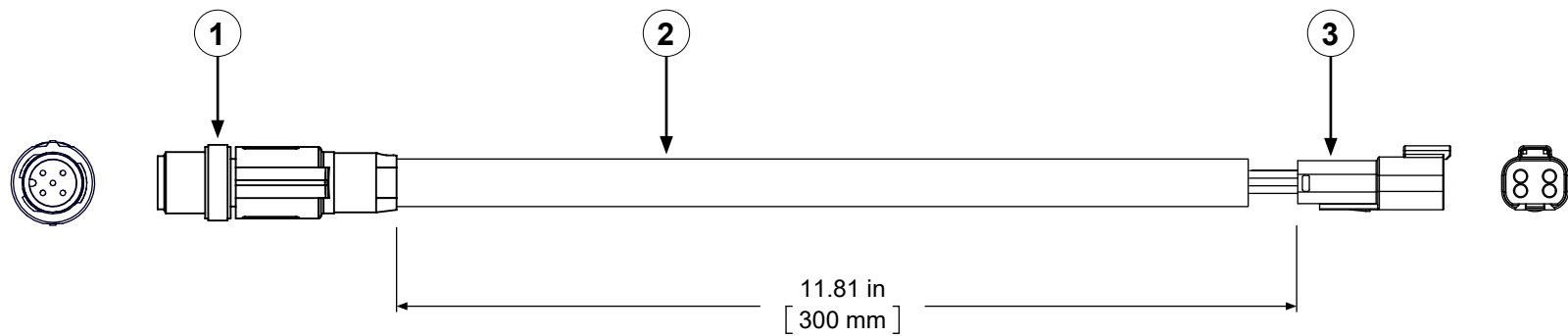

Feature	Description
1 M12 connector	This connects to the hydraulic pump connector on the control box or a sensor cable connected to the control box.
2 Cable	This is a yellow cable jacket.
3 Connector	This connects to the swashplate connector on the hydraulic pump.

## Hydraulic Pump Cable—Schematic

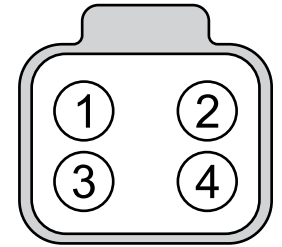

### M12 Connector

- |   |               |
|---|---------------|
| 1 | PWM out—AB    |
| 2 | PWM out—CD    |
| 3 | PWM return—AB |
| 4 | PWM return—CD |
| 5 | Shield        |

Phoenix Contact—1405879 or equivalent

### Connector

- |   |               |
|---|---------------|
| 1 | PWM out—AB    |
| 2 | PWM out—CD    |
| 3 | PWM return—AB |
| 4 | PWM return—CD |

Shell—934453102 (1)

Wedge—934483003 (1)

Sockets—match to counterpart or equivalents



## Installation Overview

This equipment is intended to be installed by a person or persons with the basic knowledge of installing similar equipment. Contact Waterous with questions about installing the equipment. The installation may require the following tasks and abilities:

- Locating, drilling, and cutting features into the apparatus.
- Routing and securing the wiring.
- Calibration and final testing.

## Preparing for the Installation

Use the following guidelines before, during, and after the installation.

- Read and understand all the installation instructions before installing the equipment.
- Prepare a suitable, well-lit area and gather all the necessary tools before you begin the installation.
- Make sure that you remove any shipping plugs or caps before installing the component.
- Make sure that you bring all fluids to operating levels before using the equipment.

## NOTICE

### Before Operation

- Read and understand all the instructions provided.
- Check all fluid levels and replenish if necessary.
- Remove all shipping plugs and install the operation plugs or caps.



## Modifying the Equipment

This equipment is intended to operate as designed. Do not remove, modify, or change the components in the system. Doing so will void the warranty. Contact Waterous for more information.

## NOTICE

### Modification

- Modifying the equipment can damage components and void your warranty.
- Do not modify the system or any of its components.

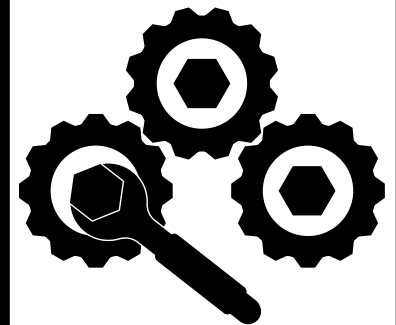

*Do not modify the system or any components. Doing so will void your warranty.*

## Optional Equipment

Be aware that the installation instruction may include optional equipment not included in your application.

## Determining Cable and Wire Routing

Use the *Wiring Best Practices* document, available at [www.waterousco.com](http://www.waterousco.com), as a guide to select and route wiring for your application.

## Plumbing Layout

Use the illustration as a guide to lay out the plumbing connections for your application.

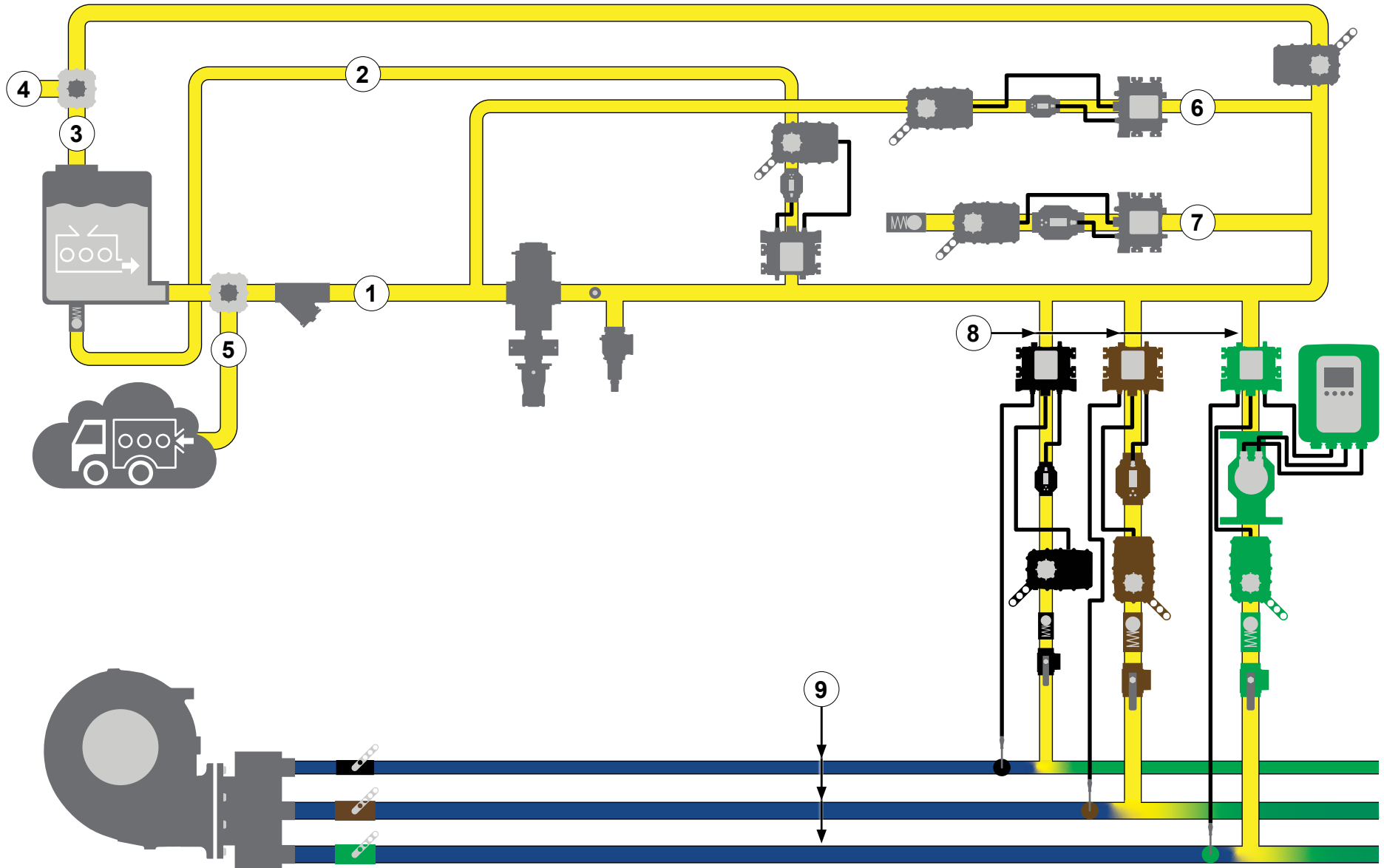



## Plumbing Layout

Feature	Description
1 Concentrate supply line	This transports concentrate around the system. This is a low-pressure line.
2 Concentrate supply refill line	This allows you to fill the on-board tank from an auxiliary source. This is a low-pressure line.
3 Priming line	This evacuates air from the concentrate pump inlet as the system primes before operation. This is a low-pressure line.
4 Priming bypass line	This prevents contamination to the concentrate during testing and training. When water is substituted for concentrate during training or testing, and there is concentrate in the supply tank, this bypass valve diverts water from the supply tank to prevent concentrate contamination. It is also very important to make sure that you drain any remaining water in the line before priming the system with concentrate. This is a low-pressure line.
5 Auxiliary concentrate supply line	This allows you to source concentrate from an external source. This is a low-pressure line.
6 Low-flow bypass line	This returns a portion of the pumped concentrate in the supply line back to the pump inlet when the desired concentrate output requires the pump to operate at an rpm that is lower than its capabilities. This is a low-pressure line.
7 Transfer line	This line allows you to transfer or relay concentrate to another location. This is a high-pressure line.
8 Discharge line assembly	This manages the concentrate injected into the solution-capable discharge. This is a high-pressure line.
9 Solution-capable discharge	This transports clear water and is capable of creating a foam solution. This is a high-pressure line.

## Concentrate Supply Component Location

Use the illustration and table to understand the hydraulic component location in the plumbing layout.

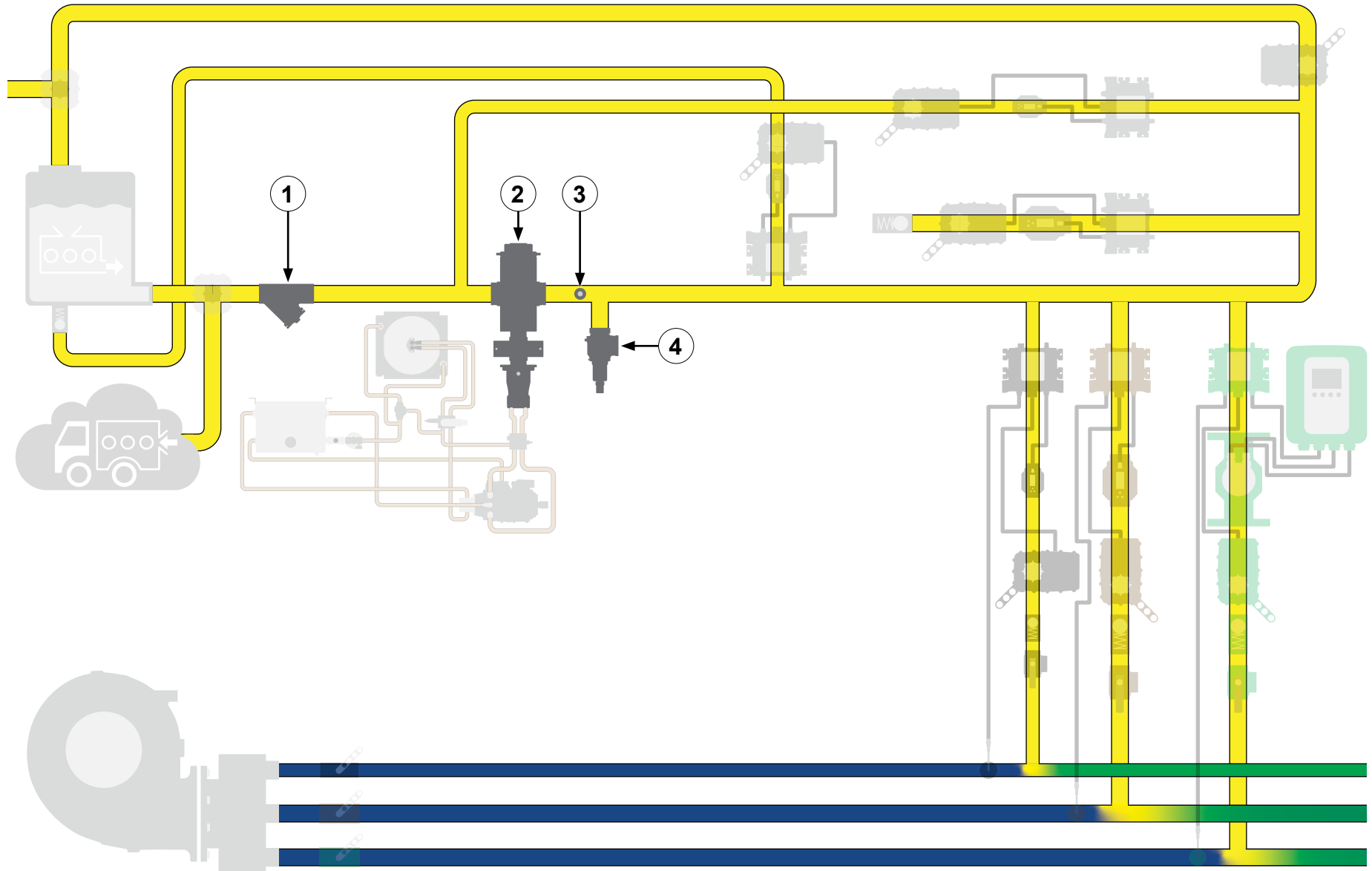

## Concentrate Supply Component Location

---

Feature	Description
1 Concentrate strainer	This collects debris that would otherwise flow through the system and potentially damage the concentrate pump.
2 Concentrate pump	This circulates the foam concentrate through the system.
3 Pressure transducer	This measures the pressure in the concentrate discharge line.
4 Pressure relief valve	This limits the pressure in the concentrate discharge manifold by opening when the pressure reaches a predetermined level.

## Hydraulic Component Layout

Use the illustration and table to understand the relationship between the hydraulic components and hose connections.

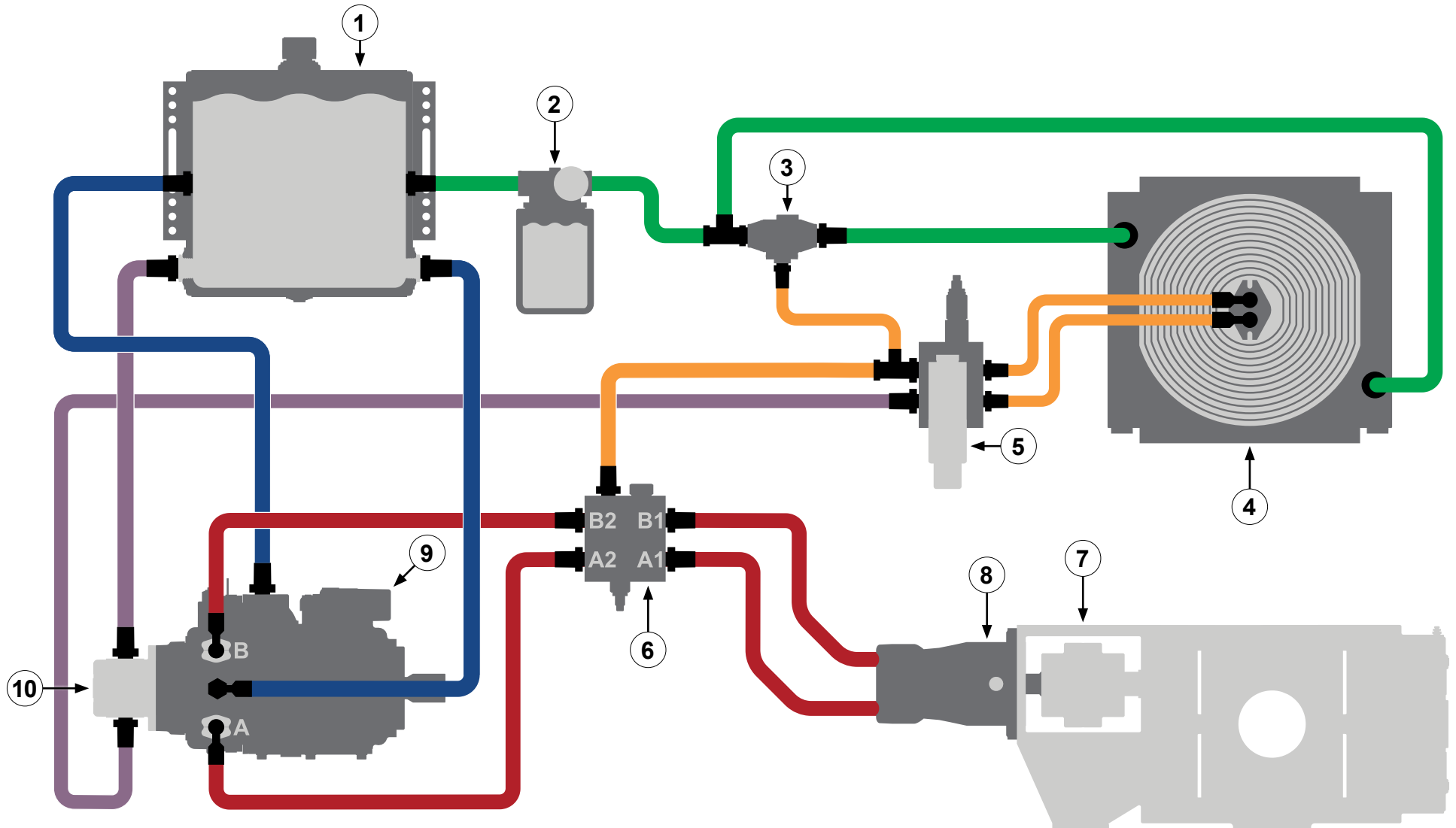

## Hydraulic Component Layout

---

Feature	Description
1 Hydraulic reservoir	This holds hydraulic fluid.
2 Hydraulic filter	This filters the hydraulic fluid.
3 Bypass valve	This allows hydraulic fluid to flow into the heat exchanger or sends it back to the reservoir.
4 Hydraulic heat exchanger	This uses a pusher fan to cool the hydraulic fluid.
5 Fan control circuit	This provides power to the heat exchanger fan.
6 Loop flush manifold	This draws hot hydraulic fluid from the main hydraulic lines and sends it to the heat exchanger.
7 Concentrate pump	This transports the concentrate through the system.
8 Hydraulic motor	This drives the concentrate pump.
9 Hydraulic pump	This drives the hydraulic motor.
10 Hydraulic fan pump	This provides power to the fan control circuit.

## Installing the Hydraulic Hoses

Use the illustration and table to install the hydraulic hoses. All hoses, connectors, and fittings are supplied by the installer.

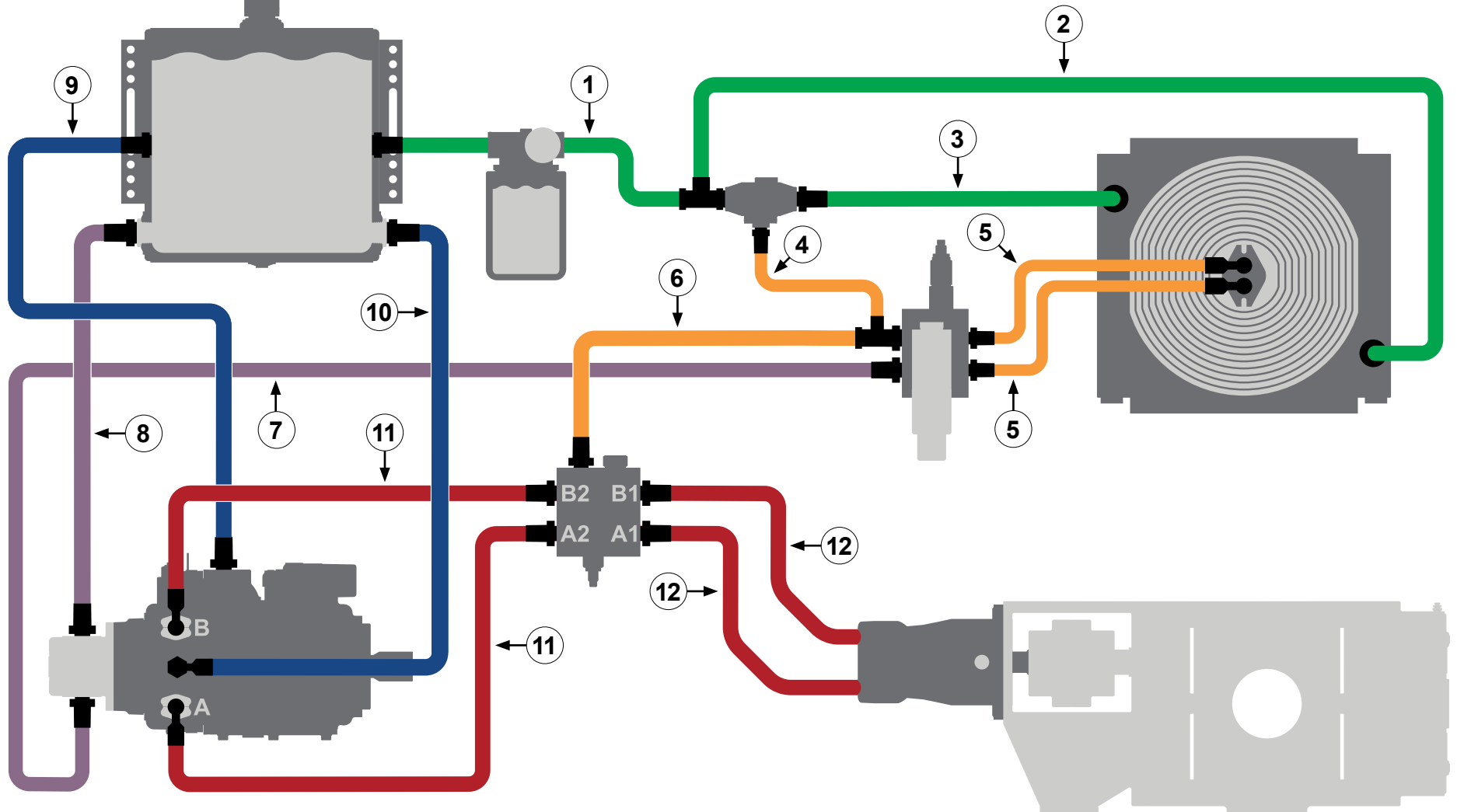

## Hydraulic Hoses—Overview

Hose	First Connector	Second Connector
1 Hydraulic filter to bypass valve—1-inch	Filter end—1-1/4 NPT	Bypass end—#16 SAE
2 Bypass valve to heat exchanger—1-inch	Bypass end—#16 SAE	Heat exchanger end—#20 SAE
3 Bypass valve to heat exchanger—1-inch	Bypass end—#16 SAE	Heat exchanger end—#20 SAE
4 Bypass valve to fan control circuit—1/2-inch	Bypass end—#16 SAE	Circuit end—#8 SAE
5 Heat exchanger to fan control circuit—1/2-inch	Heat exchanger end—#8 SAE	Circuit end—#8 SAE
6 Fan control circuit to loop flush manifold—1/2-inch	Circuit end—#8 SAE	Manifold end—#8 SAE
7 Fan control circuit to fan pump—1/2-inch	Circuit end—#8 SAE	Pump end—7/8-14 UNF 2B
8 Fan pump to hydraulic reservoir—3/4-inch	Pump end—1-1/16-12 UN 2B	Reservoir end—2 NPT
9 Hydraulic pump to hydraulic reservoir—1-inch	Pump end—1-1/16-12 UN 2B	Reservoir end—1-1/4 NPT
10 Hydraulic reservoir to hydraulic pump—1-1/4-inch	Reservoir end—2 NPT	Pump end—1-5/8-12 UN 2B
11 Hydraulic pump to loop flush manifold—1-1/4-inch	Pump end—1-inch, C62 split flange boss	Manifold end—#20 SAE
12 Loop flush manifold to concentrate pump—1-1/4-inch	Manifold end—#20 SAE	Motor end—1-inch, C62 split flange boss

## Installing the Hydraulic Motor and Concentrate Pump

Use the illustration and instructions to connect the hydraulic motor to the concentrate pump.

- 1 Install the concentrate pump into the apparatus and connect it to the concentrate plumbing.  
Refer to: "**Plumbing Layout**" on page 56.
- 2 To install the couplers, do the following:
  - Loosely install the motor hub onto the hydraulic motor.
  - Loosely install the pump hub onto the concentrate pump.
- 3 To complete the installation, do the following:
  - Place the elastomer spider between the hubs.
  - Loosely mount the hydraulic motor onto the concentrate pump.
  - Make any adjustments to the spider coupler, then securely tighten each hub.

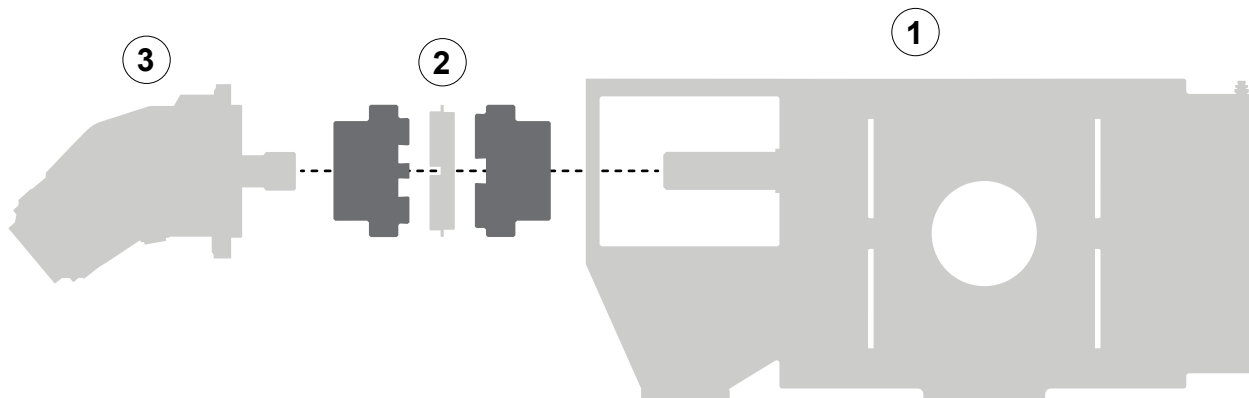



## Assembling the Fan Control Circuit

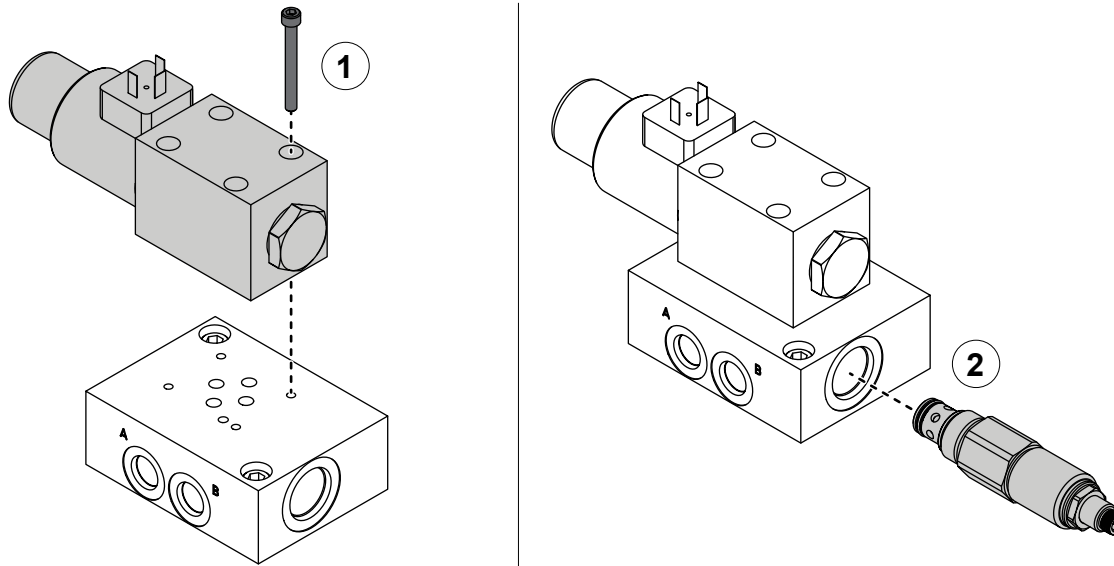

Use the illustration and instructions to assemble the fan control circuit.

- 1 Use locally sourced 10-24 x 1-1/4 inch screws to secure the solenoid directional valve to the fan control circuit.
- 2 Install the relief valve into the fan control circuit.
- 3 Install plugs into the unused P-port and T-port.

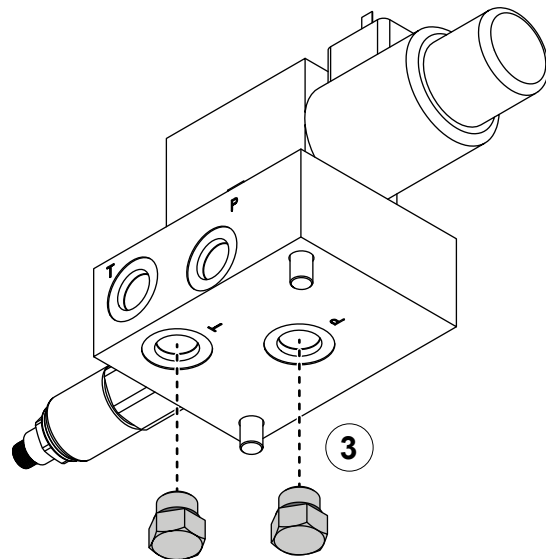

## Assembling the Hydraulic Reservoir

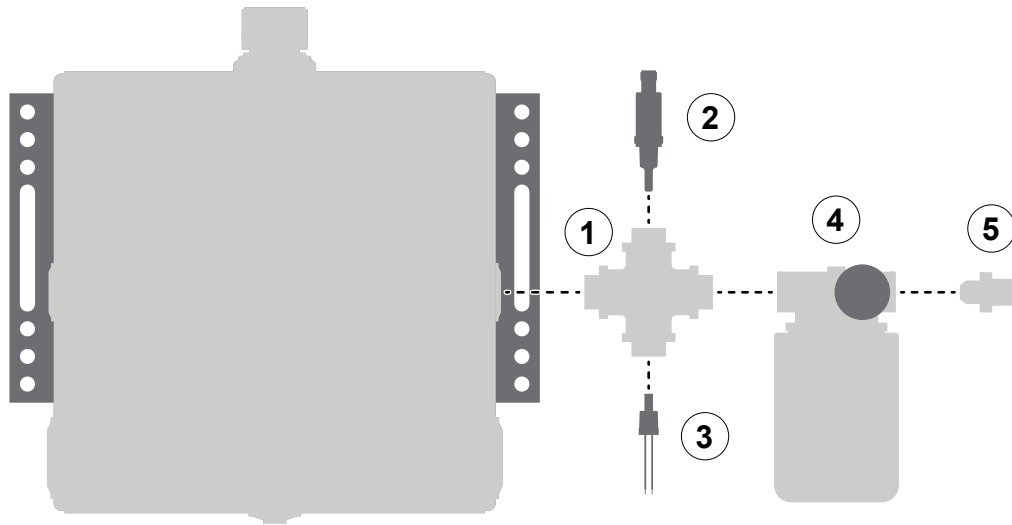

Use the illustrations and instructions to assemble the hydraulic reservoir.

**Note:** The illustrated component locations are not definitive. The ports on the reservoir are mirrored and interchangeable to suit your application.

- 1 Locally source the cross fitting and necessary adapters for the temperature sensor (1/4 NPT), temperature switch (1/4 NPT), and filter head outlet (1-1/4 NPT). Install the cross fitting into the 1 NPT reservoir port.
- 2 Install the temperature sensor into the cross fitting.
- 3 Install the temperature switch into the cross fitting.
- 4 Install the filter assembly onto the cross fitting.
- 5 Locally source and install a 1-1/4 NPT fitting into the filter head inlet.
- 6 Install the hydraulic suction strainers into the 1-1/4 NPT reservoir ports.
- 7 Install the level sensor into the 1/4 NPT reservoir port.

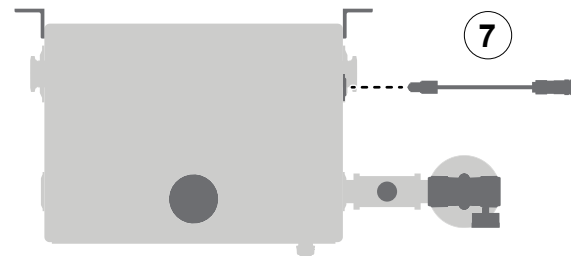
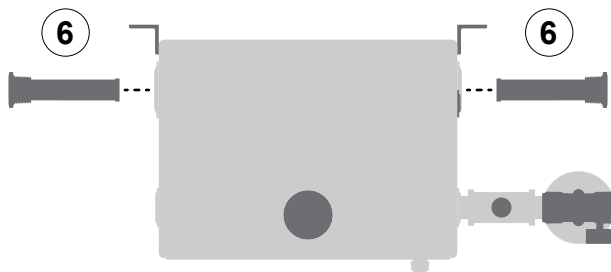

## Installing the Concentrate Strainer

Use the illustration and instructions to install the concentrate strainer.

- 1 Install the concentrate strainer downstream of the concentrate source and upstream of the concentrate pump in the concentrate line. Refer to: **"Plumbing Layout" on page 56.**

Make sure that the strainer is oriented to follow the flow. Refer to: **"Concentrate Strainer" on page 42.**

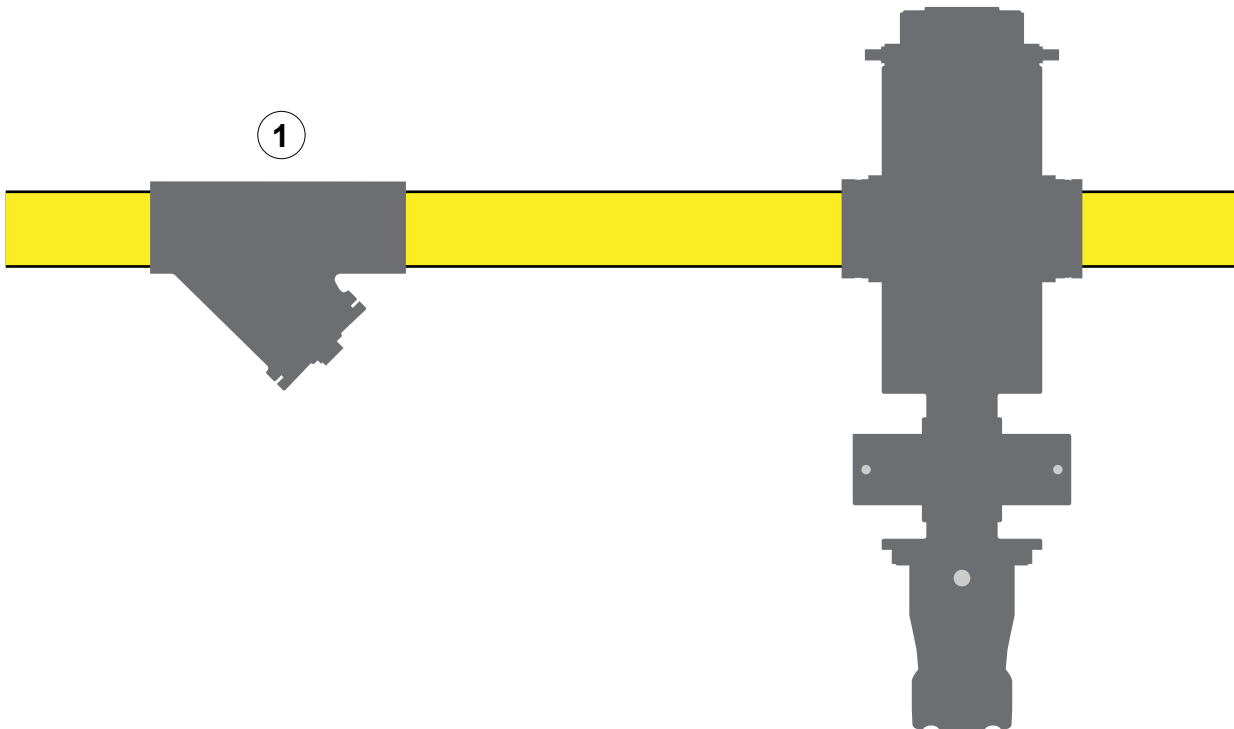

## Installing the Pressure Relief Valve

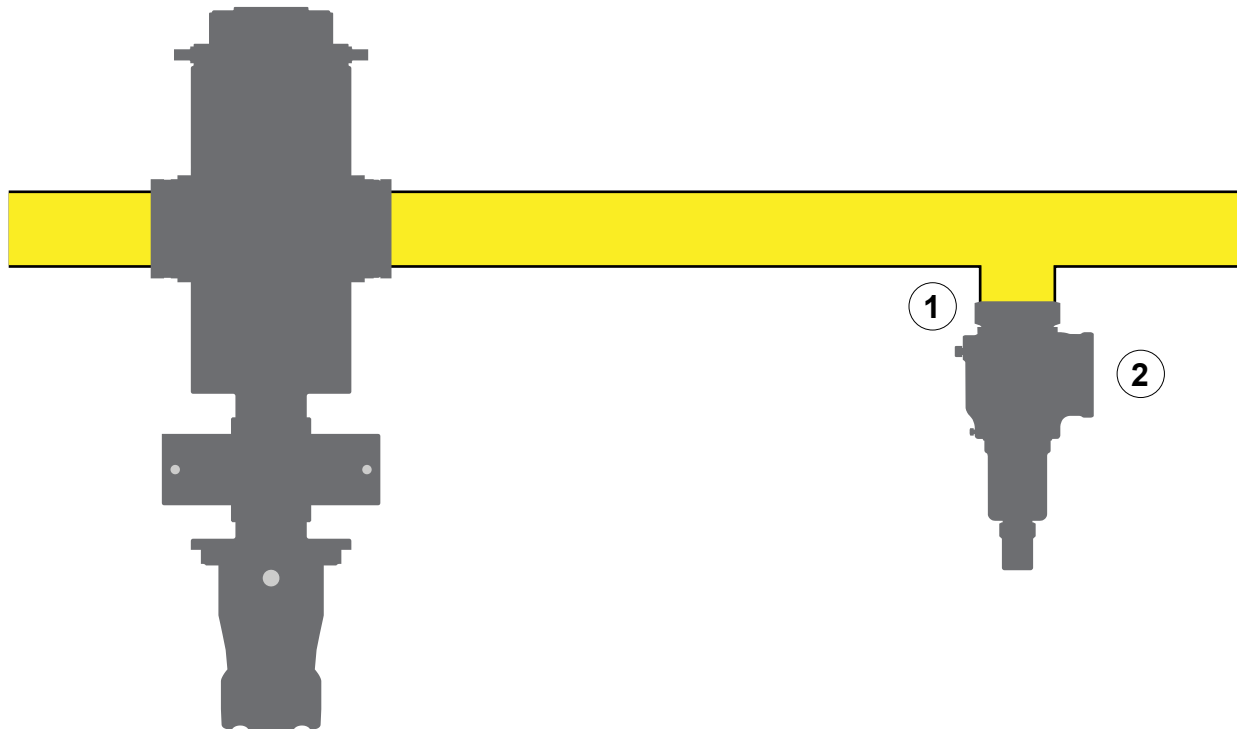

Use the illustration and instructions to install the pressure relief valve.

- 1 Install the pressure relief valve downstream of the concentrate pump in the concentrate line. Refer to: "**Plumbing Layout**" on page 56.
- 2 Connect the pressure relief valve discharge to an appropriate container or back into the low pressure side of the system to contain any relieved concentrate.

**! Pressure:** May cause personal injury or system damage. When directing high-pressure discharge into the concentrate supply tank, use baffling or other methods to manage the flow.

## Installing the Pressure Transducer

Use the illustration and instructions to install the pressure transducer.

- 1 Install the pressure transducer downstream of the concentrate pump in the concentrate line. Make sure that you install the pressure transducer a distance of at least 5 times the inner diameter of the concentrate line and downstream of the concentrate pump outlet. Refer to: "**Plumbing Layout**" on page 56.

**Note:** Do not install the pressure transducer in an elbow section of the plumbing.

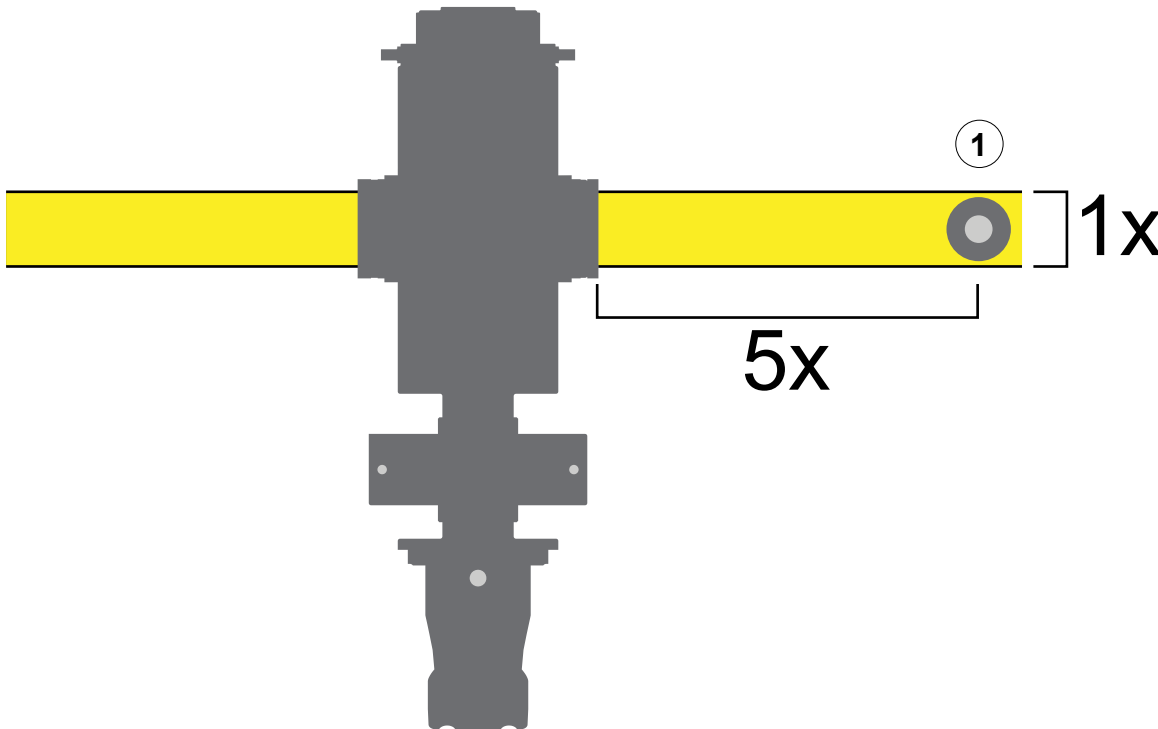

## Connecting the Hydraulic Pump to the Apparatus Drive

Use the illustration and instructions to connect the hydraulic pump to the apparatus driveline.

- 1 Locally source the appropriate components to connect the hydraulic pump to the apparatus drive.

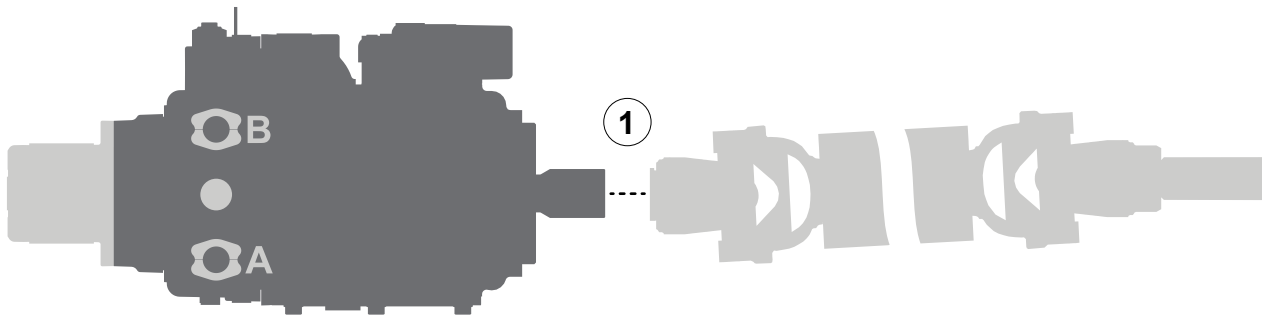

## Connecting the Concentrate Pump and Pressure Transducer

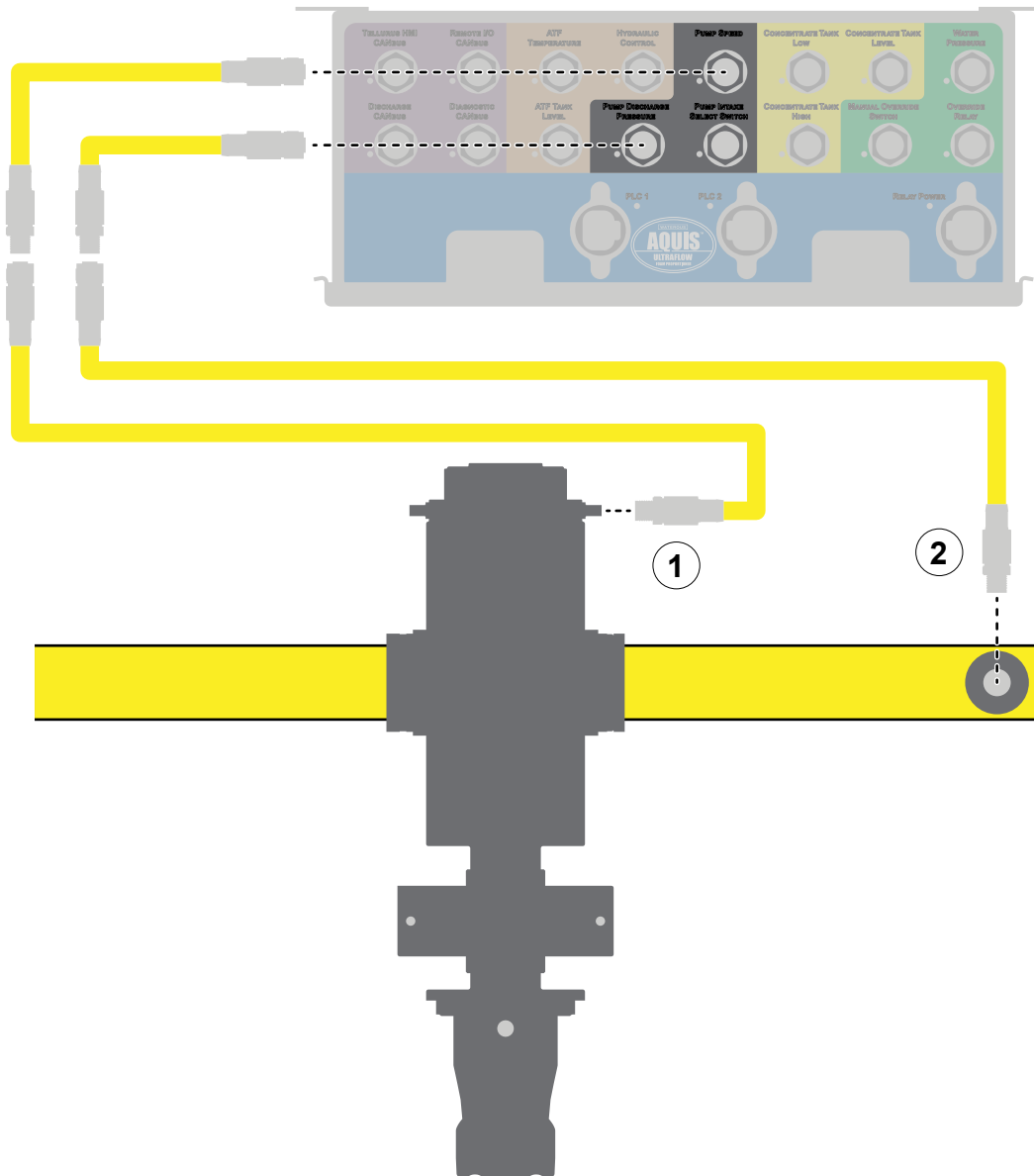

Use the illustration and instructions to connect the concentrate pump speed sensor and concentrate discharge pressure transducer to the control box.

- 1 Use a sensor cable to connect the concentrate pump speed sensor to the control box—pump speed connector.
- 2 Use a sensor cable to connect the pressure transducer to the control box—pump discharge pressure connector.

## Connecting the Hydraulic Sensors and Hydraulic Pump

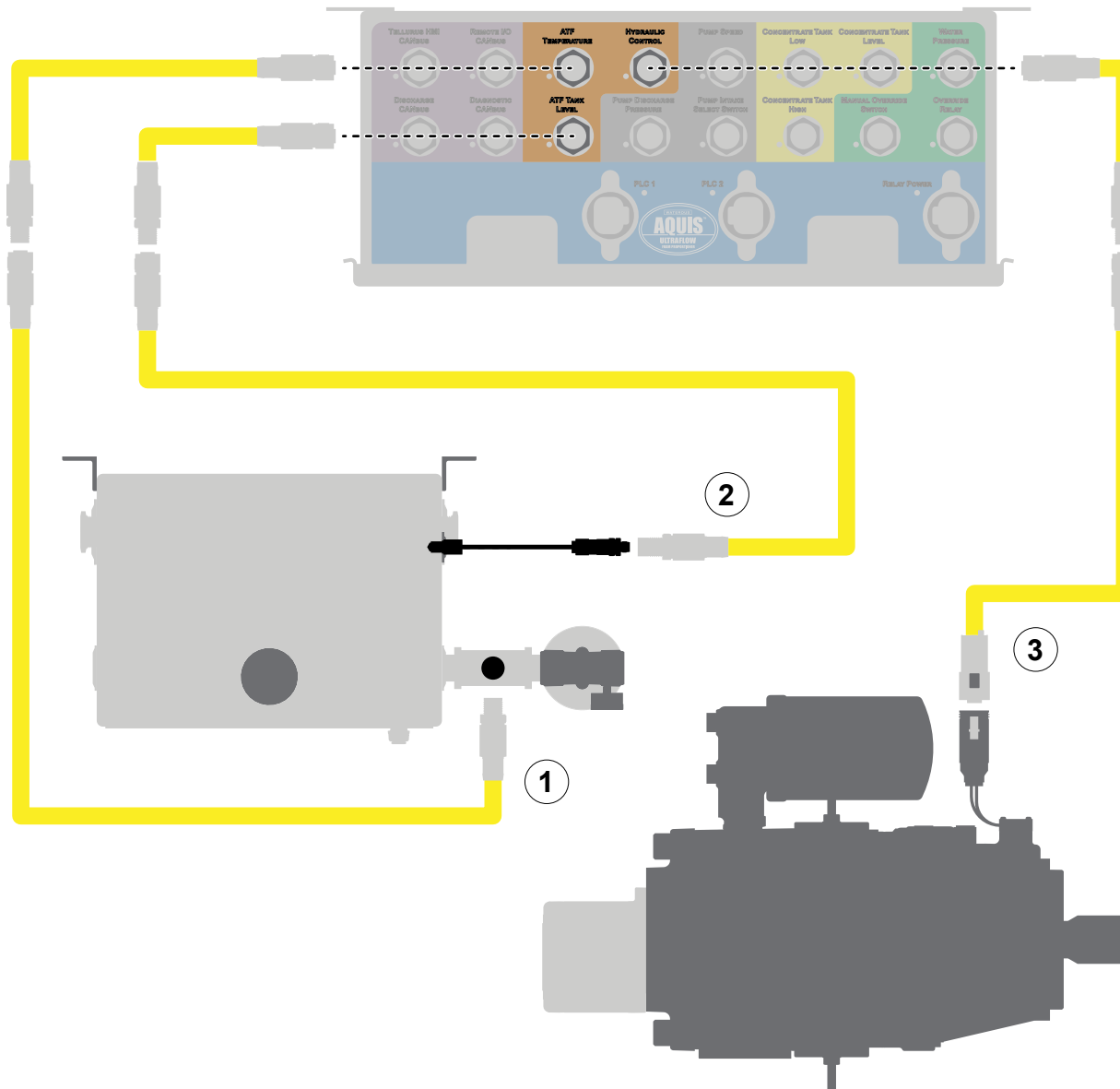

Use the illustration and instructions to connect the hydraulic sensors and hydraulic pump to the control box.

- 1 Use a sensor cable to connect the temperature sensor to the control box—ATF temperature connector.
- 2 Use a sensor cable to connect the level sensor to the control box—ATF tank level connector.
- 3 Use the hydraulic pump cable to connect the hydraulic motor to the control box—hydraulic control connector.

**Note:** A sensor cable can be used to achieve a desired length.



## Operating the Hydraulic System

The hydraulic system is managed by the Aquis UltraFlow control system hardware and software. You can operate the system through the 8-inch or 15-inch Tellurus control panel.

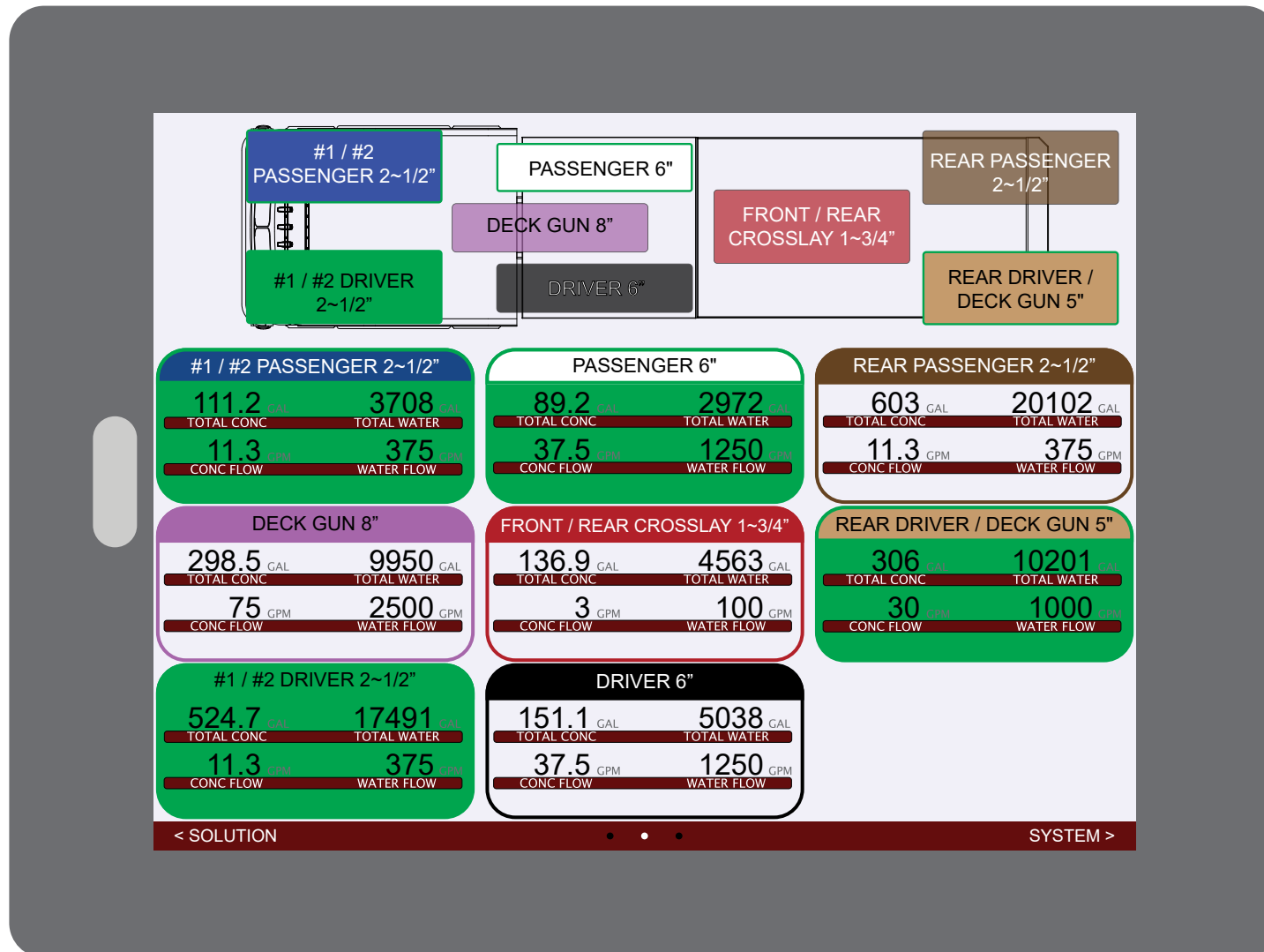

## Maintenance Schedule

---

Use the documentation that you received with your system to develop a maintenance schedule for your specific application. Consider environmental conditions, hours of operation, and other factors specific to your application to develop a suitable maintenance schedule.



**WATEROUS**

Waterous Company  
125 Hardman Avenue South  
South Saint Paul, MN 55075  
(651) 450-5000  
[www.waterousco.com](http://www.waterousco.com)