

Technical Bulletin No. 145

PB18 Series Portable Pumps

All Waterous PB18 Portable Pumps are equipped with a Briggs and Stratton V-Twin 18HP engine with a 7-quart (6.6 L) fuel tank. Other features and information are listed below:

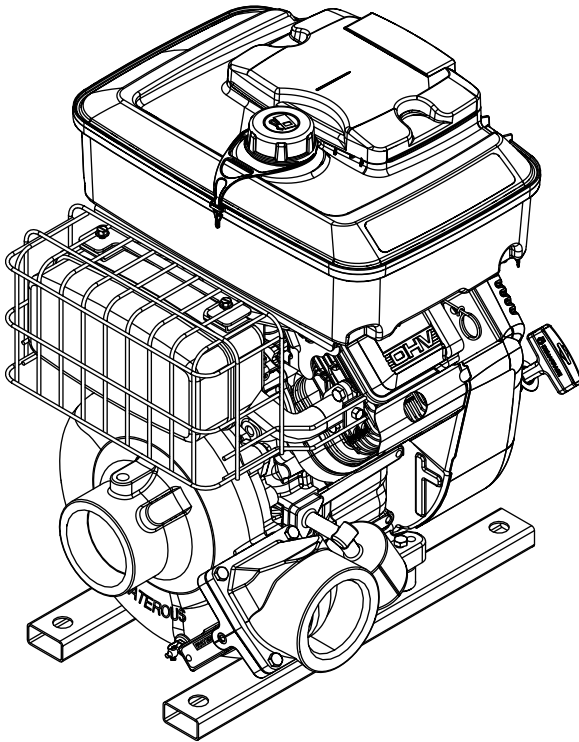

PB18

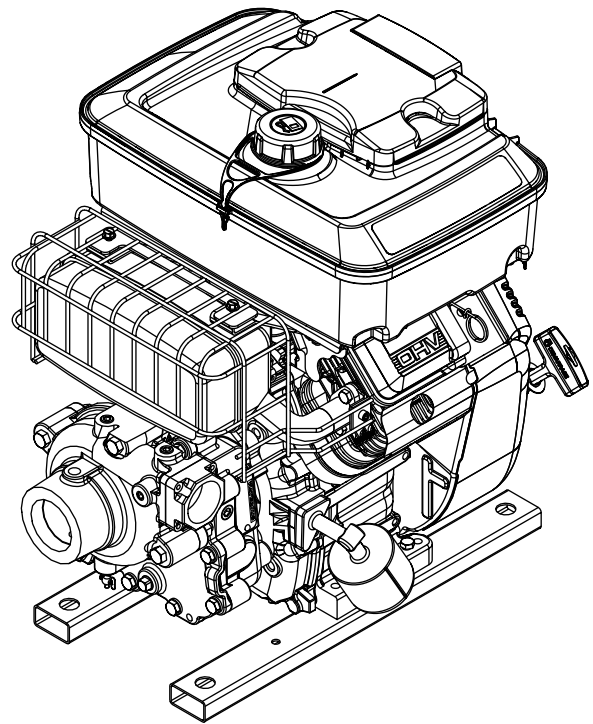

PB18-G

Features and Information:

- Fuel tank is part of the Briggs & Stratton engine located on top of the engine.
- Overall height with rail base increased by approximately 4.55 inches (11.56 cm).
- Optional operator's panel includes discharge pressure gauge, compound intake pressure gauge, start and stop control, speed control, and panel light.
- Optional combination spark arresting muffler with exhaust primer and quarter-turn bronze priming valve, which operates with push/pull knob.

PB18 Dimensions

All dimensions shown as inch/millimeter.

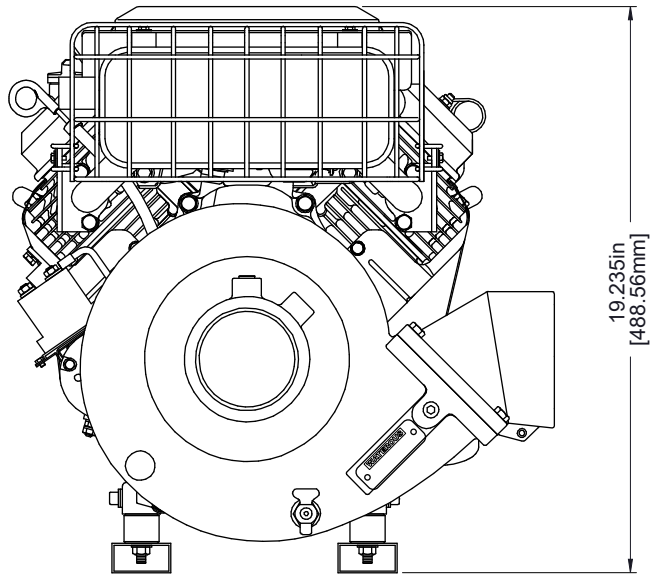

PB18 (Previous Height with Rail Base)

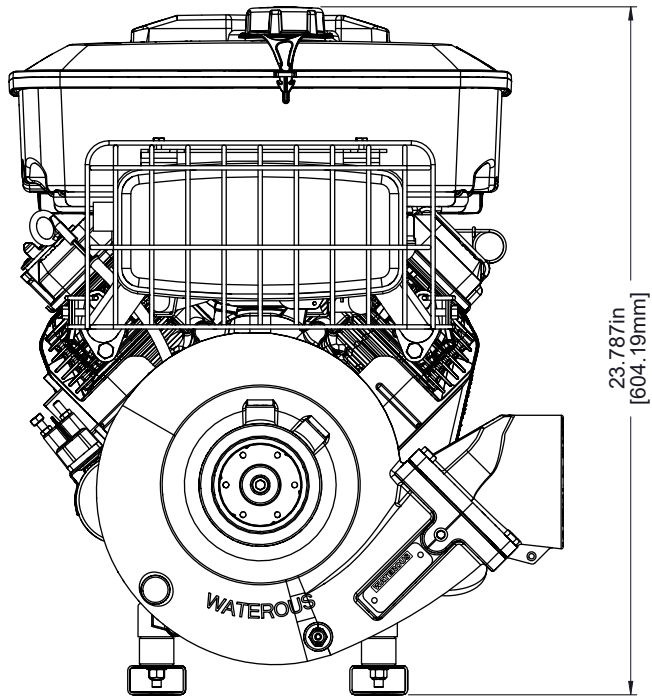

PB18 (Current Height with Rail Base)

PB18-G Dimensions

All dimensions shown as inch/millimeter.

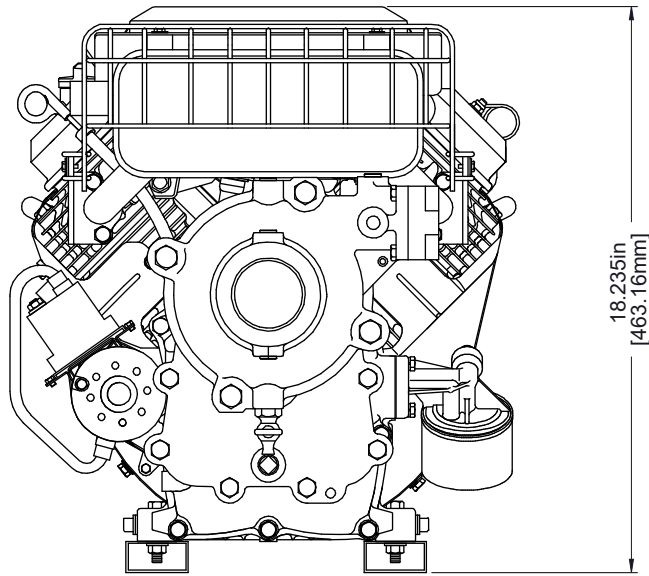

PB18-G (Previous Height with Rail Base)

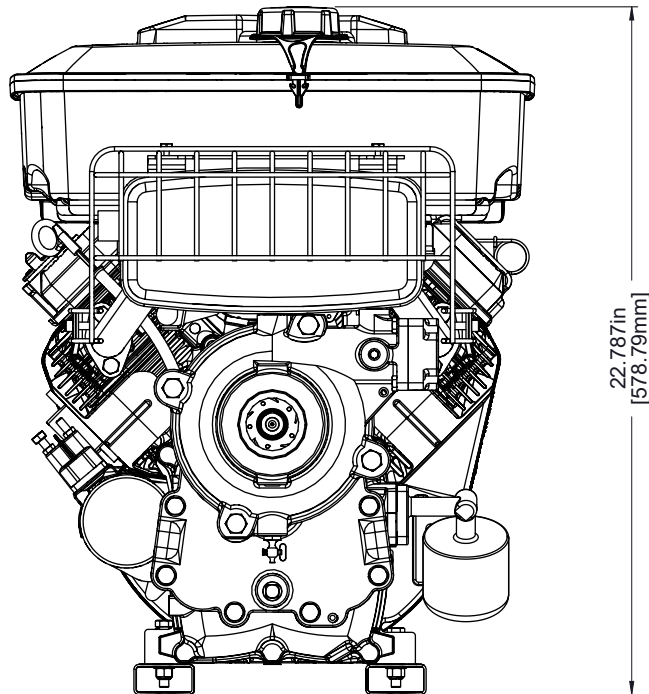

PB18-G (Current Height with Rail Base)